

**NOTICE!!**

**These documents have been scanned!**

**Do not place un-scanned documents beneath this notice!**

**Do not remove this notice from this file!**

GPO Jacket No. 560-102  
Print Order 61540  
Rise Business Services, LLC  
Job=AZ15 7/1/2019



Box Number= AZ15136



Claim Begin-End: AMC355354-AMC355354

**1 Initial Receipt**



AZ15136-10 AMC355012-AMC355391

## CLAIM INDEX

DATE PREPARED: May 30, 2001

LEAD AMC NUMBER: AMC 355354  
THRU  
ENDING AMC NUMBER: AMC 355354

<u>AMC NUMBER</u>	<u>*CLOSURE DECISION</u>	<u>CLAIM NAME</u>	<u>LOCATORS OF RECORD</u>
AMC 355354		CAT CLAW #4	BROWN KELLY R KINZENBAW DAVID R

\*FOR BLM PURPOSES ONLY

**United States Department of the Interior  
Bureau of Land Management**  
BUSINESS & SUPPORT SVCS DIV  
222 N CENTRAL AVE  
PHOENIX, AZ 85004 -2203  
Phone: (602) 417-9200

Receipt	
No:	282000

Transaction #: 297713  
Date of Transaction: 03/29/2001

CUSTOMER: DAVID R KINZENBAW  
4001 W DAHLIA  
PHOENIX, AZ 85029

4/4/01

ENTERED INTO COMPUTER

4/2/01

LINE #	QTY	COMMODITY / SUBJECT / ACTION / PRODUCT	REMARKS	UNIT PRICE	TOTAL
1	2	IAC PRODUCTS / COPIES / CASEFILE/DOCUMENT COPIES / COPIES (B/W UP TO 11X17)-\$.13/P		\$0.13	\$0.26
2	1	LOCATABLE MINERALS / MINING CLAIMS-EARNED AND ADJUDICATED / CERT OF LOCATION SVC CHG \$10 (1930)		- n/a -	\$10.00
3	1	LOCATABLE MINERALS / MINING CLAIMS-EARNED AND ADJUDICATED / LOCATION FEE \$25 (1993)		- n/a -	\$25.00
4	1	LOCATABLE MINERALS / MINING CLAIMS-EARNED AND ADJUDICATED / MAINTENANCE FEE \$100 (1993)		- n/a -	\$100.00
<b>TOTAL:</b>					<b>\$135.26</b>

PAYMENT INFORMATION			
1	AMOUNT:	\$135.26	POSTMARKED: N/A
	TYPE:	CREDIT CARD	RECEIVED: 03/29/2001
	NAME:	KINZENBAW, DAVID R 4001 W DAHLIA PHOENIX AZ 85029	
	CARD NO:	XXXXXXXXXXXX7175	AUTH CODE: 078187
	NAME ON CARD:	KINZENBAW/DAVID R	
	EXPIRES:	03/31/2003	
	SIGNATURE:		

REMARKS

CASE SERIAL NUMBER INFORMATION		
TRNS #	LINE #	CASES
297713	2	AMC00355354
297713	3	AMC00355354
297713	4	AMC00355354

This receipt was generated by the automated BLM Collections and Billings System and is a paper representation of a portion of the official electronic record contained therein.

**NOTICE!!**

**These documents have been scanned!**

**Do not place un-scanned documents beneath this notice!**

**Do not remove this notice from this file!**

GPO Jacket No. 560-102  
Print Order 61540  
Rise Business Services, LLC  
Job=AZ15 7/1/2019



Box Number= AZ15136



Claim Begin-End: AMC355354-AMC355354

**2 Correspondence**



AZ15136-10

AMC355012-AMC355391

**NO  
DOCUMENTS  
FOUND**

NO DOCUMENTS FOUND  
NO DOCUMENTS FOUND

**NOTICE!!**

**These documents have been scanned!**

**Do not place un-scanned documents beneath this notice!**

**Do not remove this notice from this file!**

GPO Jacket No. 560-102  
Print Order 61540  
Rise Business Services, LLC  
Job=AZ15 7/1/2019



Box Number= AZ15136



Claim Begin-End: AMC355354-AMC355354

**3 Transfers**



AZ15136-10

AMC355012-AMC355391

**United States Department of the Interior**  
**Bureau of Land Management**  
 BUSINESS & SUPPORT SVCS DIV  
 222 N CENTRAL AVE  
 PHOENIX, AZ 85004 -2203  
 Phone: (602) 417-9200

Receipt	
No:	1101592

<b>Transaction #:</b> 1140108	<i>AMC 356328</i> <i>AMC 355354</i>
<b>Date of Transaction:</b> 06/28/2005	
<b>CUSTOMER:</b> BEVERLY BROWN 10502 CHERRY TREE LN SUN CITY, AZ 85373	<i>AMC 266964</i> <i>268020</i>

*277387*

LINE #	QTY	DESCRIPTION	REMARKS	UNIT PRICE	TOTAL
1	1.00	LOCATABLE MINERALS / MINING CLAIMS-NOT NEW-UNADJUD, ONE AUTH NO. ONLY / MINING CLAIM MONEY RECEIVED (455) CASES: AMC356330/\$70.00	TRF/12	- n/a -	70.00
<b>TOTAL:</b>					<b>\$70.00</b>

PAYMENT INFORMATION			
1	AMOUNT:	\$70.00	POSTMARKED: N/A
	TYPE:	CHECK	RECEIVED: 06/28/2005
	CHECK NO:	3440	
	NAME:	BROWN, BEVERLY 10502 CHERRY TREE LN SUN CITY AZ 85373	

**REMARKS**

This receipt was generated by the automated BLM Collections and Billing System and is a paper representation of a portion of the official electronic record contained therein.

*12 transfers x 5 = \$60*  
*Extra \$10 refunded as*

November 3, 2004

**RE: Transfer of Mining Claims in Lieu of a Will**

Dear Bureau of Land Management,

On June 14, 2004, my husband Kelly R. Brown died without any will or probate from the court. I, Beverly M. Brown, resident of Arizona and wife of Kelly R. Brown, declare that I am the sole heir to his estate.

Attached please find a copy of Kelly R. Brown's death certificate.

I am requesting that the BLM remove his name from the mining claims listed below and that I be listed as the new claimant. I am enclosing \$10.00 (\$5.00 per claim) as per your instructions August 17, 2004.

<u>Serial Number</u>	<u>Mining Claim Name</u>	<u>County</u>	<u>Amt Paid</u>
AMC356330	CATCLAW #7	Maricopa	\$ 5.00
AMC355354	CATCLAW #4	Maricopa	\$ 5.00
<b>Total Check Amount</b>			<b>\$10.00</b>

The new claimant of the above listed claims will be:

Beverly M. Brown  
10502 Cherry Tree Lane  
Sun City, AZ 85373

Should you have any questions or need further information, I can be reached at 623-972-0057. Thank you for your assistance in this matter.

Beverly M. Brown

*Beverly M. Brown*

Date this 28 day of June

STATE OF ARIZONA }

County of Maricopa }

This instrument was acknowledged before me

this 28 day of June, 2005 by

*Gloria L. Parrish*

Notary Public

My commission will expire

*Aug 19, 2006*

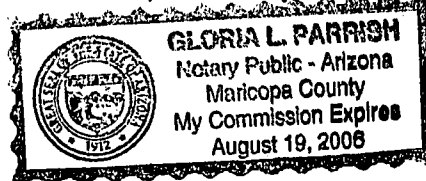

RECEIVED  
 B.L.M. AZ STATE OFFICE  
 PHOENIX, ARIZONA  
 2005 JUN 28 P 2:35

**ENTERED INTO COMPUTER**

10/25/05 AB

2  
TMC



November 3, 2004

**RE: Transfer of Mining Claims in Lieu of a Will**

Dear Bureau of Land Management,

On June 14, 2004, my husband Kelly R. Brown died without any will or probate from the court. I, Beverly M. Brown, resident of Arizona and wife of Kelly R. Brown, declare that I am the sole heir to his estate.

Attached please find a copy of Kelly R. Brown's death certificate.

I am requesting that the BLM remove his name from the mining claims listed below and that I be listed as the new claimant. I am enclosing \$50.00 (\$5.00 per claim) as per your instructions August 17, 2004.

<u>Serial Number</u>	<u>Mining Claim Name</u>	<u>County</u>	<u>Amt Paid</u>
AMC266964	DONKEY #1	Yavapai	\$ 5.00
AMC266965	DONKEY #2	Yavapai	\$ 5.00
AMC266966	DONKEY #3	Yavapai	\$ 5.00
AMC268020	DONKEY #4	Yavapai	\$ 5.00
AMC268021	DONKEY #5	Yavapai	\$ 5.00
AMC268022	DONKEY #6	Yavapai	\$ 5.00
AMC277387	DONKEY #7	Yavapai	\$ 5.00
AMC277388	DONKEY #8	Yavapai	\$ 5.00
AMC356328	BUZZARD #1	Yavapai	\$ 5.00
AMC356329	BUZZARD #2	Yavapai	\$ 5.00
<b>Total Check Amount</b>			<b><u>\$50.00</u></b>

The new claimant of the above listed claims will be:

Beverly M. Brown  
10502 Cherry Tree Lane  
Sun City, AZ 85373

Should you have any questions or need further information, I can be reached at 623-972-0057. Thank you for your assistance in this matter.

Beverly M. Brown

*Beverly M. Brown*

Date this 28 day of June, 2005

STATE OF ARIZONA

County of Maricopa

This instrument was acknowledged before me

this 28 day of June, 2005 by

*Gloria R. Parrish*

Notary Public

My commission will expire Aug 19, 2006

RECEIVED  
B.L.M. AZ STATE OFFICE  
2005 JUN 28 P 2:35  
PHOENIX, ARIZONA

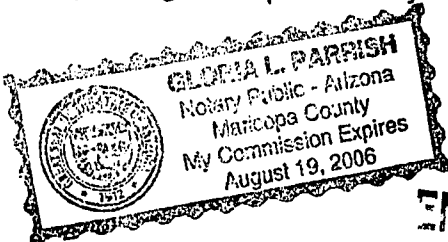

ENTERED INTO COMPUTER

10/25/05 AR

10  
hmc

CERTIFICATION OF VITAL RECORDS

STATE OF ARIZONA

ORIGINAL STATE COPY

STATE OF ARIZONA DEPARTMENT OF HEALTH SERVICES - OFFICE OF VITAL RECORDS CERTIFICATE OF DEATH

DEATH NO. D-10004-020069

NAME OF DECEASED 1. <b>KELLY R BROWN</b>			SEX 2. <b>MALE</b>	DATE OF DEATH 3. <b>JUNE 14, 2004</b>		
RACE (e.g., white, black, American Indian, (specify tribe) etc.) 4A. <b>WHITE</b>		WAS DESCENDANT OF HISPANIC ORIGIN (SPECIFY YES OR NO) B. <b>NO</b>		IF YES, INDICATE MEXICAN, SPANISH, PUERTO RICAN, CUBAN, ETC. C.		WAS DECEASED EVER IN U.S. ARMED FORCES? (SPECIFY YES OR NO) 5. <b>NO</b>
PLACE OF DEATH 6. <b>MARICOPA</b>		TOWN OR CITY <b>SUN CITY</b>		HOSPITAL OR INSTITUTION (IF RESIDENCE, GIVE STREET ADDRESS) <b>SUN HEALTH CARE CENTER</b>		<input type="checkbox"/> DOA <input type="checkbox"/> OP EMER <input checked="" type="checkbox"/> IN PATIENT
DATE OF BIRTH 7. <b>APRIL 7 1934</b>		AGE (YEARS LAST BIRTHDAY) 8A. <b>70</b>	IF UNDER 1 YEAR MOS. DAYS B.	IF UNDER 1 DAY HRS. MIN. C.	MARRIED, NEVER MARRIED, WIDOWED, DIVORCED (SPECIFY) 9. <b>MARRIED</b>	SURVIVING SPOUSE (IF WIFE, GIVE MAIDEN NAME) 10. <b>BEVERLY HYLTON</b>
STATE AND CITY OF BIRTH (If not in USA, name country) 11. <b>JONESVILLE, NORTH CAROLINA</b>		CITIZEN OF WHAT COUNTRY? SPECIFY 12. <b>U.S.A.</b>		SOCIAL SECURITY NO. 13. <b>243-46-0530</b>		USUAL OCCUPATION (Give kind of work done most of working life, even if retired) 14A. <b>CLERGY</b>
USUAL RESIDENCE 15. <b>ARIZONA</b>		COUNTY <b>MARICOPA</b>		TOWN OR CITY <b>SUN CITY</b>		D ZIP CODE <b>85373</b>
STREET ADDRESS OF R.F.D. 15E. <b>10502 WEST CHERRY TREE LANE</b>		INSIDE CITY LIMITS? (SPECIFY Yes or No) 15F. <b>YES</b>	ON RESERVATIONS (SPECIFY Yes or No) 15G. <b>NO</b>	PREVIOUS STATE OF RESIDENCE 18. <b>CALIFORNIA</b>		ELEMENTARY SECONDARY (0-12) A. <b>9</b>
FATHER'S NAME 19. <b>BEDFORD BROWN</b>			MOTHER'S MAIDEN NAME 20. <b>WAVERLY CHEEKS</b>			
INFORMANT'S SIGNATURE 21. <b>BEVERLY BROWN</b>			RELATIONSHIP TO DECEASED 22. <b>WIFE</b>		ADDRESS 23. <b>10502 WEST CHERRY TREE LANE SUN CITY, AZ. 85373</b>	
BURIAL, CREMATION, REMOVAL, OTHER (Specify) 24. <b>CREMATION</b>	DATE 25. <b>6/17/2004</b>	CEMETERY OR CREMATORY - NAME/LOCATION 26. <b>SUNLAND CREMATORY, SUN CITY, AZ.</b>			EMBALMER'S SIGNATURE 27A. <b>NOT EMBALMED</b>	
FUNERAL HOME 28. <b>SUNLAND MORTUARY 15826 DEL WEBB BLVD., SUN CITY, AZ. 85351</b>			FUNERAL DIRECTOR or person acting as such (SIGNATURE) 29A. <b>STUART T. GRIMSTAD</b>			CERT. NO. B. <b>1102</b>
TO THE BEST OF MY KNOWLEDGE, DEATH OCCURRED AT THE TIME, DATE AND PLACE AND DUE TO THE CAUSE(S) STATED. 30. SIGNATURE AND TITLE <b>MD.</b>		DATE SIGNED (Mo., Day, Year) 31. <b>JUNE 15, 2004</b>		HOUR OF DEATH 32. <b>0520</b>		ON THE BASIS OF EXAMINATION AND/OR INVESTIGATION, IN MY OPINION DEATH OCCURRED AT THE TIME, DATE AND PLACE DUE TO THE CAUSE(S) AND MANNER STATED. 34. SIGNATURE AND TITLE 35.
NAME OF ATTENDING PHYSICIAN OF OTHER THAN CERTIFIER (Type or print) 33. <b>DR. ARLEVE CONTE MD.</b>		MEDICAL EXAMINER OR TRIBAL LAW ENFORCEMENT AUTHORITY ONLY 36.		PRONOUNCED DEAD (Mo., Day, Year) 37. <b>ON</b>		38. AT
NAME AND ADDRESS OF CERTIFIER, PHYSICIAN, MEDICAL EXAMINER OR TRIBAL LAW ENFORCEMENT AUTHORITY 39. <b>M. RIVERA MD. 10401 W. THUNDERBIRD BLVD., SUN CITY, AZ. 85351</b>			AUTHORIZED FOR CREMATION (SPECIFY) 40. <input checked="" type="checkbox"/> Yes <input type="checkbox"/> No		MEDICAL EXAMINER'S SIGNATURE 41. <b>Archie M. Rivera, MD</b>	
DATE REGISTERED 42. <b>JUN 23 2004</b>	REG. FILE NO. 43. <b>12277</b>	REGISTRAR'S SIGNATURE 44. <b>Stacie Cavano Deputy</b>		REG. DISTRICT 45. <b>0705</b>	DATE REC'D IN STATE OFFICE 46.	
SEVERALLY LIST CONDITIONS IF ANY LEADING TO IMMEDIATE CAUSE ENTER UNDERLYING CAUSE TO DISEASE OR INJURY THAT INITIATED EVENTS RESULTING IN DEATH LAST PART		A IMMEDIATE CAUSE (FINAL DISEASE OR CONDITION RESULTING IN DEATH) (ENTER ONLY ONE CAUSE ON EACH LINE) <b>UNKNOWN MEDICAL CAUSES</b>				APPROXIMATE INTERVAL BETWEEN ONSET AND DEATH
PART I		B DUE TO OR AS A CONSEQUENCE OF				
PART II		C DUE TO OR AS A CONSEQUENCE OF				
PART II. Other significant conditions contributing to death but not resulting in the underlying cause given in Part I				AUTOPSY (Specify Yes or No) 49. <b>NO</b>	WAS CASE REFERRED TO MEDICAL EXAMINER (Specify Yes or No) 50. <b>YES</b>	
MANNER OF DEATH <input type="checkbox"/> NATURAL CAUSES <input type="checkbox"/> ACCIDENT <input type="checkbox"/> SUICIDE <input type="checkbox"/> HOMICIDE <input type="checkbox"/> PENDING INVESTIGATION <input type="checkbox"/> UNDETERMINED		DATE OF INJURY 52. MO DAY YR <b>MO DAY YR</b>	HOUR 53. M <b>M</b>	INJURY AT WORK? (Specify Yes or No) 54. <b>NO</b>		
51.		PLACE OF INJURY (At home, farm, street, factory, office building, etc.) 56.		WHERE LOCATED? 57.	STREET ADDRESS CITY OR TOWN STATE	
SUPPLEMENTARY ENTRIES 58.						

VS-2 (Rev. 1-89)

CERTIFIED COPY OF VITAL RECORDS

STATE OF ARIZONA }  
COUNTY OF MARICOPA } SS

June 28, 2004

DATE ISSUED

This is a true and exact reproduction of the document officially registered and placed on file in the VITAL RECORDS SECTION, DEPARTMENT OF HEALTH SERVICES, PHOENIX, ARIZONA issued under the authority of A.R.S. 36-341, and by direction of:

*Jonathan B. Weisbuch*  
Jonathan B. Weisbuch, M.D., M.P.H.  
Local Registrar  
Director, Department of Public Health



4250974

**NOTICE!!**

**These documents have been scanned!**

**Do not place un-scanned documents beneath this notice!**

**Do not remove this notice from this file!**

GPO Jacket No. 560-102  
Print Order 61540  
Rise Business Services, LLC  
Job=AZ15 7/1/2019



Box Number= AZ15136



Claim Begin-End: AMC355354-AMC355354

**4 Annual Filings**



AZ15136-10

AMC355012-AMC355391

353269 277387 356328 353844  
 363920 354046 358408 354046  
 362141 266964 ~~355354~~  
 351675 268020 355375

**MAINTENANCE FEE PAYMENT**

Claimant Name: Beverly Brown/David Kinzenbauer  
 Address: 10502 Cherry Tree Ln,  
 City: Sun City State: AZ Zip: 85373  
 Telephone: C. 623-512-6895 Dave 623-680-2999  
 E-mail address: \_\_\_\_\_  
 Signature: \_\_\_\_\_

RECEIVED  
 BLM AZ STATE OFFICE  
 PHOENIX, ARIZONA  
 2010 AUG 21 A 10:59  
 BLM  
 Date  
 Stamp

Check here if this is a change of address.

LINE NO.	AMC NUMBER	CLAIM/SITE NAME	COUNTY RECORDER DATA (If available)	TWP	RNG	SEC
1	353844	Red Roaster	Maricopa	7N	3W	21
2	354046	Catclaw #1	Maricopa	7N	3W	13
3	354047	Catclaw #2	Maricopa	7N	3W	13
4	355277	Catclaw #3	Maricopa	7N	3W	24
5	355354	Catclaw #4	Maricopa	7N	3W	13
6	355375	Catclaw #5	Maricopa	7N	3W	24
7	355376	Catclaw #6	Maricopa	7N	3W	24
8	356330	Catclaw #7	Maricopa	7N	3W	24
9	358409	Havelina #1	Maricopa	7N	3W	22
10	358408	Havelina #2	Maricopa	7N	3W	22

List additional claims on Form MCF114.

Bureau of Land Management  
 Arizona State Office  
[www.blm.gov/az/](http://www.blm.gov/az/)

No. of Claims\*: 32 x \$155 = 4960  
 Check No: \_\_\_\_\_ Init. TEZ  
 Receipt No.: 4240647  
 For BLM Use Only

\* \$155 per lode mining claim, mill site, or tunnel site; and \$155 for each 20 acres or portion thereof for each placer mining claim.

Form: MCF112  
 Revised July 2014

This form is available from the Arizona Geological Survey and may be reproduced.

**ENTERED**  
 AUG 27 2018  
 BY: Ran

**SUPPLEMENTAL ATTACHMENT**

May be used with the following forms for listing additional mining claims:

Check One.

- Affidavit of Performance of Annual Work
- Maintenance Fee Payment
- Notice of Intent to Hold Mining Claims
- Notice of Non-Liability for Labor and Materials Furnished
- Quit claim Deed

BLM  
Date  
Stamp

PHOENIX, ARIZONA

2010 AUG 21 A 10:59

RECEIVED  
RIMAZ STATE OFFICE

LINE NO.	AMC NUMBER	CLAIM/SITE NAME	COUNTY RECORDER DATA (if available)	TWP	RANGE	SEC
11	266964	DonKey#1	yav.	8N	3W	35
12	266965	DonKey#2	yav.	8N	3W	35
13	266966	DonKey#3	yav.	8N	3W	35
14	268020	DonKey#4	yav.	8N	3W	35
15	268021	DonKey#5	yav.	8N	3W	35
16	268022	DonKey#6	yav.	8N	3W	35
17	277387	DonKey#7	yav.	8N	3W	35
18	277388	DonKey#8	yav.	8N	3W	35
19	354048	DonKey#9	yav.	8N	3W	35
20	354049	DonKey#10	yav.	8N	3W	35
21	356328	Buzzard#1	yav.	7N	3W	12
22	356329	Buzzard#2	yav.	7N	3W	12
23	362141	Buzzard#3	yav.	7N	3W	12
24	351675	Select#1	yav.	7N	3W	10
25	351676	Select#2	yav.	7N	3W	10
26	351677	Select#3	yav.	7N	3W	10
27	353269	Hog	yav.	8N	3W	36
28	363922	Old Mill#1	yav.	7N	3W	10
29	363923	Old Mill#2	yav.	7N	3W	10

Form MCF114  
Revised July 2014

This form is available from the Arizona Geological Survey and may be reproduced.

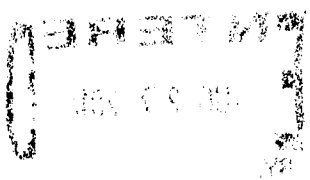

**SUPPLEMENTAL ATTACHMENT**

May be used with the following forms for listing additional mining claims:

Check One.

- Affidavit of Performance of Annual Work
- Maintenance Fee Payment
- Notice of Intent to Hold Mining Claims
- Notice of Non-Liability for Labor and Materials Furnished
- Quit claim Deed

RECEIVED  
D. M. AZ STATE OFFICE  
PHOENIX, ARIZONA  
2018 AUG 21 A 10:59  
BLM  
Date  
Stamp

LINE NO.	AMC NUMBER	CLAIM/SITE NAME	COUNTY RECORDER DATA (If available)	TWP	RNG	SEC
30	355276	Brass Ring	Maricopa	7N	3W	21
31	363920	Catclaw #8	Maricopa	7N	3W	13
32	363921	Catclaw #9	Maricopa	7N	3W	13

**United States Department of the Interior**  
**Bureau of Land Management**  
 DIV OF LANDS, MINRLS & ENERGY  
 ONE N CENTRAL AVE  
 PHOENIX, AZ 85004 -4427  
 Phone: 602-417-9200

Receipt

No: 4240647

<b>Transaction #:</b> 4356056	
<b>Date of Transaction:</b> 08/21/2018	
<b>CUSTOMER:</b>	
BEVERLY BROWN 10502 W CHERRY TREE LN SUN CITY,AZ 85373-1024 US	

LINE #	QTY	DESCRIPTION	REMARKS	UNIT PRICE	TOTAL
1	1.00	LOCATABLE MINERALS / MINING CLAIMS-NOT NEW-UNADJUD,ONE AUTH NO. ONLY / MINING CLAIM MONEY RECEIVED CASES: AMC353844/\$4960.00	2019 MAINT/32	- n/a -	4960.00
<b>TOTAL:</b>					<b>\$4,960.00</b>

PAYMENT INFORMATION					
NOTE: Items will appear on credit card statement as "Bureau of Land Mgmt CO".					
1	AMOUNT:	2480.00	POSTMARKED:	N/A	
	TYPE:	CASH	RECEIVED:	08/21/2018	
	NAME:	DAVID, KINZENBAW 10502 W CHERRY TREE LN SUN CITY AZ 85373-1024 US			
2	AMOUNT:	2480.00	POSTMARKED:	N/A	
	TYPE:	CREDIT CARD	RECEIVED:	08/21/2018	
	NAME:	BROWN, BEVERLY 10502 W CHERRY TREE LN SUN CITY AZ 85373-1024 US			
	CARD NO:	XXXXXXXXXXXX3407	AUTH CODE:	01664C	
	NAME ON CARD:	BEVERLY M BROWN			
	SIGNATURE:				

<b>REMARKS</b>

This receipt was generated by the automated BLM Collections and Billing System and is a paper representation of a portion of the official electronic record contained therein.

**United States Department of the Interior**  
**Bureau of Land Management**  
 DIV OF LANDS, MINRLS & ENERGY  
 ONE N CENTRAL AVE  
 PHOENIX, AZ 85004 -4427  
 Phone: 602-417-9200

Receipt

No: 4240647

<b>Transaction #:</b> 4356056	
<b>Date of Transaction:</b> 08/21/2018	
<b>CUSTOMER:</b>	
BEVERLY BROWN 10502 W CHERRY TREE LN SUN CITY, AZ 85373-1024 US	

LINE #	QTY	DESCRIPTION	REMARKS	UNIT PRICE	TOTAL
1	1.00	LOCATABLE MINERALS / MINING CLAIMS-NOT NEW-UNADJUD, ONE AUTH NO. ONLY / MINING CLAIM MONEY RECEIVED CASES: AMC353844/\$4960.00	2019 MAINT/32	- n/a -	4960.00
<b>TOTAL:</b>					<b>\$4,960.00</b>

PAYMENT INFORMATION					
NOTE: Items will appear on credit card statement as "Bureau of Land Mgmt CO".					
1	AMOUNT:	2480.00	POSTMARKED:	N/A	
	TYPE:	CASH	RECEIVED:	08/21/2018	
	NAME:	DAVID, KINZENBAW 10502 W CHERRY TREE LN SUN CITY AZ 85373-1024 US			
2	AMOUNT:	2480.00	POSTMARKED:	N/A	
	TYPE:	CREDIT CARD	RECEIVED:	08/21/2018	
	NAME:	BROWN, BEVERLY 10502 W CHERRY TREE LN SUN CITY AZ 85373-1024 US			
	CARD NO:	XXXXXXXXXXXX3407	AUTH CODE:	01664C	
	NAME ON CARD:	BEVERLY M BROWN			
	SIGNATURE:	<i>Beverly Brown</i>			

REMARKS

This receipt was generated by the automated BLM Collections and Billing System and is a paper representation of a portion of the official electronic record contained therein.



353269 277387 356328 354046  
 363920 356328 358408 355276  
 362141 266964 **355354**  
 351675 268020 355375

**MAINTENANCE FEE PAYMENT**

Claimant Name: Beverly Brown/David Kinzenbacher  
 Address: 10502 Cherry Tree Ln.  
 City: Sun City State: AZ Zip: 85373  
 Telephone: C. 623-512-6895 Dave 623-680-2999  
 E-mail address: \_\_\_\_\_  
 Signature: \_\_\_\_\_

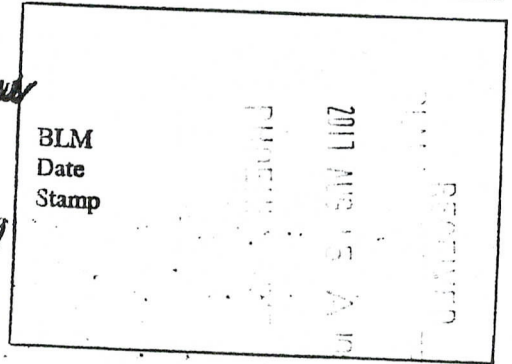

Check here if this is a change of address.

LINE NO.	AMC NUMBER	CLAIM/SITE NAME	COUNTY RECORDER DATA (If available)	TWP	RNG	SEC
1	353844	Red Roaster	Maricopa	7N	3W	21
2	354046	Catclaw #1	Maricopa	7N	3W	13
3	354047	Catclaw #2	Maricopa	7N	3W	13
4	355277	Catclaw #3	Maricopa	7N	3W	24
5	355354	Catclaw #4	Maricopa	7N	3W	13
6	355375	Catclaw #5	Maricopa	7N	3W	24
7	355376	Catclaw #6	Maricopa	7N	3W	24
8	356330	Catclaw #7	Maricopa	7N	3W	24
9	358409	Havelina #1	Maricopa	7N	3W	22
10	358408	Havelina #2	Maricopa	7N	3W	22

List additional claims on Form MCF114.

No. of Claims\*: 32 x \$155 = 4960  
 Check No.: CASH/ARD Init. PETZ  
 Receipt No.: 3937486  
 For BLM Use Only

Bureau of Land Management  
 Arizona State Office  
[www.blm.gov/az/](http://www.blm.gov/az/)

\* \$155 per lode mining claim, mill site, or tunnel site; and \$155 for each 20 acres or portion thereof for each placer mining claim.

Form: MCF112  
 Revised July 2014

This form is available from the Arizona Geological Survey and may be reproduced.

**ENTERED**  
**AUG 16 2017**  
 BY: AAm

**SUPPLEMENTAL ATTACHMENT**

May be used with the following forms for listing additional mining claims:

Check One.

- Affidavit of Performance of Annual Work
- Maintenance Fee Payment
- Notice of Intent to Hold Mining Claims
- Notice of Non-Liability for Labor and Materials Furnished
- Quit claim Deed

BLM Date Stamp	PHOENIX	2017 AUG 15	RECEIVED
----------------------	---------	-------------	----------

LINE NO.	AMC NUMBER	CLAIM/SITE NAME	COUNTY RECORDER DATA (If available)	TWP	RNG	SEC
11	266964	DonKey #1	yav.	8N	3W	35
12	266965	DonKey #2	yav.	8N	3W	35
13	266966	DonKey #3	yav.	8N	3W	35
14	268020	DonKey #4	yav.	8N	3W	35
15	268021	DonKey #5	yav.	8N	3W	35
16	268022	DonKey #6	yav.	8N	3W	35
17	277387	DonKey #7	yav.	8N	3W	35
18	277388	DonKey #8	yav.	8N	3W	35
19	354048	DonKey #9	yav.	8N	3W	35
20	354049	DonKey #10	yav.	8N	3W	35
21	356328	Buzzard #1	yav.	7N	3W	12
22	356329	Buzzard #2	yav.	7N	3W	12
23	362141	Buzzard #3	yav.	7N	3W	12
24	351675	Select #1	yav.	7N	3W	10
25	351676	Select #2	yav.	7N	3W	10
26	351677	Select #3	yav.	7N	3W	10
27	353269	Hog	yav.	8N	3W	36
28	363922	Old Mill #1	yav.	7N	3W	10
29	363923	Old Mill #2	yav.	7N	3W	10

Form MCF114  
Revised July 2014



**United States Department of the Interior**  
**Bureau of Land Management**  
 DIV OF LANDS, MINRLS & ENERGY  
 ONE N CENTRAL AVE  
 PHOENIX, AZ 85004 -4427  
 Phone: 602-417-9200

Receipt

No: 3937486

<b>Transaction #:</b> 4047112	
<b>Date of Transaction:</b> 08/15/2017	
<b>CUSTOMER:</b>	
BEVERLY BROWN 10502 W CHERRY TREE LN SUN CITY, AZ 85373-1024 US	

LINE #	QTY	DESCRIPTION	REMARKS	UNIT PRICE	TOTAL
1	1.00	LOCATABLE MINERALS / MINING CLAIMS- NOT NEW-UNADJUD, ONE AUTH NO. ONLY / MINING CLAIM MONEY RECEIVED CASES: AMC353844/\$4960.00	2018 MAINT/32	- n/a -	4960.00
<b>TOTAL:</b>					<b>\$4,960.00</b>

PAYMENT INFORMATION				
NOTE: Items will appear on credit card statement as "Bureau of Land Mgmt CO".				
1	AMOUNT:	2500.00	POSTMARKED: N/A	
	TYPE:	CASH	RECEIVED: 08/15/2017	
	NAME:	BROWN, BEVERLY 10502 W CHERRY TREE LN SUN CITY AZ 85373-1024 US		
2	AMOUNT:	2460.00	POSTMARKED: N/A	
	TYPE:	CREDIT CARD	RECEIVED: 08/15/2017	
	NAME:	BROWN, BEVERLY 10502 W CHERRY TREE LN SUN CITY AZ 85373-1024 US		
	CARD NO:	XXXXXXXXXXXX3407	AUTH CODE: 05139C	
	NAME ON CARD:	BEVERLY M BROWN		
	EXPIRES:	03/2018		
	SIGNATURE:			

REMARKS
---------

266964 355276  
 268020 355354  
 277387 355375  
 351675 356328  
 353269 358408  
 353844 362141  
 354046 363920

RECEIVED  
 AZ STATE OFFICE  
 2016 AUG 22 A 10: 51  
 PHOENIX, ARIZONA

**MAINTENANCE FEE PAYMENT**

Claimant Name: Beverly Brown/David Kinzenbacher  
 Address: 10502 Cherry Tree Ln.  
 City: Sun City State: AZ Zip: 85373  
 Telephone: C. 623-512-6895 Dave 623-680-2999  
 E-mail address: \_\_\_\_\_  
 Signature: Beverly Brown/Dave Kinzenbacher

BLM  
 Date  
 Stamp

Check here if this is a change of address.

LINE NO.	AMC NUMBER	CLAIM/SITE NAME	COUNTY RECORDER DATA (If available)	TWP	RNG	SEC
1	353844	Red Roaster	Maricopa	7N	3W	21
2	354046	Catclaw #1	Maricopa	7N	3W	13
3	354047	Catclaw #2	Maricopa	7N	3W	13
4	355277	Catclaw #3	Maricopa	7N	3W	24
5	355354	Catclaw #4	Maricopa	7N	3W	13
6	355375	Catclaw #5	Maricopa	7N	3W	24
7	355376	Catclaw #6	Maricopa	7N	3W	24
8	356330	Catclaw #7	Maricopa	7N	3W	24
9	358409	Havelina #1	Maricopa	7N	3W	22
10	358408	Havelina #2	Maricopa	7N	3W	22

List additional claims on Form MCF114.

No. of Claims\*: 32 x \$155 = 4960  
 Check No: CC-Cash Init. 4MC  
 Receipt No.: 3636726  
 For BLM Use Only

Bureau of Land Management  
 Arizona State Office  
[www.blm.gov/az/](http://www.blm.gov/az/)

\* \$155 per lode mining claim, mill site, or tunnel site; and \$155 for each 20 acres or portion thereof for each placer mining claim.

Form: MCF112  
 Revised July 2014

SUPPLEMENTAL ATTACHMENT

May be used with the following forms for listing additional mining claims:

Check One.

- Affidavit of Performance of Annual Work
- Maintenance Fee Payment
- Notice of Intent to Hold Mining Claims
- Notice of Non-Liability for Labor and Materials Furnished
- Quit claim Deed

BLM Date Stamp	RECEIVED BLM AZ STATE OFFICE 2016 AUG 22 A 10: 57 PHOENIX, ARIZONA
----------------------	-----------------------------------------------------------------------------

LINE NO.	AMC NUMBER	CLAIM/SITE NAME	COUNTY RECORDER DATA (If available)	TWP	RNG	SEC
11	266964	DonKey#1	yav.	8N	3W	35
12	266965	DonKey#2	yav.	8N	3W	35
13	266966	DonKey#3	yav.	8N	3W	35
14	268020	DonKey#4	yav.	8N	3W	35
15	268021	DonKey#5	yav.	8N	3W	35
16	268022	DonKey#6	yav.	8N	3W	35
17	277387	DonKey#7	yav.	8N	3W	35
18	277388	DonKey#8	yav.	8N	3W	35
19	354048	DonKey#9	yav.	8N	3W	35
20	354049	DonKey#10	yav.	8N	3W	35
21	356328	Buzzard#1	yav.	7N	3W	12
22	356329	Buzzard#2	yav.	7N	3W	12
23	362141	Buzzard#3	yav.	7N	3W	12
24	351675	Select#1	yav.	7N	3W	10
25	351676	Select#2	yav.	7N	3W	10
26	351677	Select#3	yav.	7N	3W	10
27	353269	Hog	yav.	8N	3W	36
28	363922	Old Mill#1	yav.	7N	3W	10
29	363923	Old Mill#2	yav.	7N	3W	10

Form MCF114  
Revised July 2014



**United States Department of the Interior**  
**Bureau of Land Management**  
 DIV OF LANDS, MINRLS & ENERGY  
 ONE N CENTRAL AVE  
 PHOENIX, AZ 85004 -4427  
 Phone: 602-417-9200

Receipt

No: 3636726

<b>Transaction #:</b> 3740593	
<b>Date of Transaction:</b> 08/22/2016	
<b>CUSTOMER:</b>	
BEVERLY BROWN 10502 W CHERRY TREE LN SUN CITY, AZ 85373-1024 US	

LINE #	QTY	DESCRIPTION	REMARKS	UNIT PRICE	TOTAL
1	1.00	LOCATABLE MINERALS / MINING CLAIMS- NOT NEW-UNADJUD, ONE AUTH NO. ONLY / MINING CLAIM MONEY RECEIVED CASES: AMC353844/\$4960.00	MAINT 2017/32	- n/a -	4960.00
<b>TOTAL:</b>					<b>\$4,960.00</b>

PAYMENT INFORMATION			
NOTE: Items will appear on credit card statement as "Bureau of Land Mgmt CO".			
1	AMOUNT:	2480.00	POSTMARKED: N/A
	TYPE:	CASH	RECEIVED: 08/22/2016
	NAME:	KINZENBAW, DAVID 13047 N 19TH ST PHOENIX AZ 85022 US	
2	AMOUNT:	2480.00	POSTMARKED: N/A
	TYPE:	CREDIT CARD	RECEIVED: 08/22/2016
	NAME:	BROWN, BEVERLY 10502 W CHERRY TREE LN SUN CITY AZ 85373-1024 US	
	CARD NO:	XXXXXXXXXXXX3407	AUTH CODE: 09305C
	NAME ON CARD:	BEVERLY M BROWN	
	EXPIRES:	03/2018	
	SIGNATURE:		

REMARKS	
---------	--

**ENTERED**  
 AUG 24 2016  
 BY: *[Signature]*



This receipt was generated by the automated BLM Collections and Billing System and is a paper representation of a portion of the official electronic record contained therein.

363920 ~~358408~~ 358408  
 355276 ~~355276~~ 266964  
 362141 268020  
 351675 277387  
 353269 354046

353844  
 354046  
 355276  
 355354  
 355375  
 356328

**MAINTENANCE FEE PAYMENT**

Claimant Name: Beverly Brown/David Kinzenbaw  
 Address: 10502 Cherry Tree Ln  
 City: Sun City State: AZ Zip: 85373  
 Telephone: C. 623-512-6895 Dave C.  
 E-mail address: bev Brown@CenturyLink.Com  
 Signature: \_\_\_\_\_

RECEIVED  
 BLM AZ STATE OFFICE  
 2015 AUG 18 A 10:52  
 PHOENIX, ARIZONA  
 BLM  
 Date  
 Stamp

Check here if this is a change of address.

LINE NO.	AMC NUMBER	CLAIM/SITE NAME	COUNTY RECORDER DATA (If available)	TWP	RNG	SEC
1	353844	Red Rooster	Maricopa	7N	3W	21
2	354046	Catclaw #1	Maricopa	7N	3W	13
3	354047	Catclaw #2	Maricopa	7N	3W	13
4	355277	Catclaw #3	Maricopa	7N	3W	24
5	355354	Catclaw #4	Maricopa	7N	3W	13
6	355375	Catclaw #5	Maricopa	7N	3W	24
7	355376	Catclaw #6	Maricopa	7N	3W	24
8	356330	Catclaw #7	Maricopa	7N	3W	24
9	358409	Havelina #1	Maricopa	7N	3W	22
10	358408	Havelina #2	Maricopa	7N	3W	22

List additional claims on Form MCF114.

Bureau of Land Management  
 Arizona State Office  
[www.blm.gov/az/](http://www.blm.gov/az/)

No. of Claims: 32 x \$155 = 4,960  
 Check No: CCF Cash Unit: YML  
 Receipt No.: 3369773  
 For BLM Use Only

Form: MCF112  
 Revised July 2009

This form is available from the Arizona Department of Mines and Mineral Resources and may be reproduced.

BY: Ram

**SUPPLEMENTAL ATTACHMENT**

May be used with the following forms for listing additional mining claims:

Check One.

- Affidavit of Performance of Annual Work
- Maintenance Fee Payment
- Notice of Intent to Hold Mining Claims
- Notice of Non-Liability for Labor and Materials Furnished

RECEIVED  
BLM AZ STATE OFFICE  
2015 AUG 18 AM 10:00  
PHOENIX, ARIZONA

BLM  
Date  
Stamp

LINE NO.	AMC NUMBER	CLAIM/SITE NAME	COUNTY RECORDER DATA (if available)	TWP	RNG	SEC
11	266964	Don Key #1	yav.	8N	3W	35
12	266965	Don Key #2	yav.	8N	3W	35
13	266966	Don Key #3	yav.	8N	3W	35
14	268020	Don Key #4	yav.	8N	3W	35
15	268021	Don Key #5	yav.	8N	3W	35
16	268022	Don Key #6	yav.	8N	3W	35
17	277387	Don Key #7	yav.	8N	3W	35
18	277388	Don Key #8	yav.	8N	3W	35
19	354048	Don Key #9	yav.	8N	3W	35
20	354049	Don Key #10	yav.	8N	3W	35
21	356328	Buzzard #1	yav.	7N	3W	12
22	356329	Buzzard #2	yav.	7N	3W	12
23	362141	Buzzard #3	yav.	7N	3W	12
24	351675	Select # 1	yav.	7N	3W	10
25	351676	Select # 2	yav.	7N	3W	10
26	351677	Select #3	yav.	7N	3W	10
27	353269	Hog	yav.	8N	3W	36
28	363922	Old Mill #1	yav.	7N	3W	10
29	363923	Old Mill #2	yav.	7N	3W	10

Form MCF114  
Revised June 2005

This form is available from the Arizona Department of Mines & Mineral Resources and may be reproduced.



**United States Department of the Interior**  
**Bureau of Land Management**  
 LANDS/RECREATION & PLANNING  
 ONE N CENTRAL AVE  
 PHOENIX, AZ 85004 -2203  
 Phone: 602-417-9200

Receipt

No: 3369773

<b>Transaction #:</b> 3467931	
<b>Date of Transaction:</b> 08/18/2015	
<b>CUSTOMER:</b>	
BEVERLY BROWN 10502 W CHERRY TREE LN SUN CITY, AZ 85373-1024 US	

LINE #	QTY	DESCRIPTION	REMARKS	UNIT PRICE	TOTAL
1	1.00	LOCATABLE MINERALS / MINING CLAIMS- NOT NEW-UNADJUD, ONE AUTH NO. ONLY / MINING CLAIM MONEY RECEIVED CASES: AMC353844/\$4960.00	MAINT 2016/32	- n/a -	4960.00
<b>TOTAL:</b>					<b>\$4,960.00</b>

PAYMENT INFORMATION			
NOTE: Items will appear on credit card statement as "Bureau of Land Mgmt CO".			
1	AMOUNT:	2480.00	POSTMARKED: N/A
	TYPE:	CASH	RECEIVED: 08/18/2015
	NAME:	BROWN, BEVERLY 10502 W CHERRY TREE LN SUN CITY AZ 85373-1024 US	
2	AMOUNT:	2480.00	POSTMARKED: N/A
	TYPE:	CREDIT CARD	RECEIVED: 08/18/2015
	NAME:	BROWN, BEVERLY 10502 W CHERRY TREE LN SUN CITY AZ 85373-1024 US	
	CARD NO:	XXXXXXXXXXXX3407	AUTH CODE: 05434C
	NAME ON CARD:	BEVERLY M BROWN	
	EXPIRES:	03/2018	
	SIGNATURE:		

REMARKS
<i>RAM</i>

AMC 266964  
 268020  
 363920 355276 353844  
 355354 277387  
 355375 351675  
 356328 353269  
 358408 354046  
 362141

**MAINTENANCE FEE PAYMENT**

Claimant Name: Beverly Brown/David Kinzenbaw  
 Address: 10502 Cherry Tree LN  
 City: SUN CITY State: AZ Zip: 85373  
 Telephone: C. 623-512-6895 Dave C.  
 E-mail address: bev.brown@CenturyLink.Com  
 Signature: \_\_\_\_\_

RECEIVED  
 AZ STATE OFFICE  
 PHOENIX, ARIZONA  
 2014 AUG 19 A 11:05  
 BLM  
 Date  
 Stamp

Check here if this is a change of address.

LINE NO.	AMC NUMBER	CLAIM/SITE NAME	COUNTY RECORDER DATA (If available)	TWP	RNG	SEC
1	353844	Red Rooster	Maricopa	7N	3W	21
2	354046	Catclaw #1	Maricopa	7N	3W	13
3	354047	Catclaw #2	Maricopa	7N	3W	13
4	355277	Catclaw #3	Maricopa	7N	3W	24
5	355354	Catclaw #4	Maricopa	7N	3W	13
6	355375	Catclaw #5	Maricopa	7N	3W	24
7	355376	Catclaw #6	Maricopa	7N	3W	24
8	356330	Catclaw #7	Maricopa	7N	3W	24
9	358409	Havelina #1	Maricopa	7N	3W	22
10	358408	Havelina #2	Maricopa	7N	3W	22

List additional claims on Form MCF114.

Bureau of Land Management  
 Arizona State Office  
 www.blm.gov/az/

No. of Claims: 32 x \$155 = 4,960  
 Check No. CC cash Init. 4ME  
 Receipt No.: 3105837  
 For BLM Use Only

Form: MCF112  
 Revised July 2009

This form is available from the Arizona Department of Mines and Mineral Resources and may be reproduced.

~~# 3197101~~

INTERE  
 AUG 22 2014  
 BY: RAM

**SUPPLEMENTAL ATTACHMENT**

May be used with the following forms for listing additional mining claims:

Check One.

- Affidavit of Performance of Annual Work
- Maintenance Fee Payment
- Notice of Intent to Hold Mining Claims
- Notice of Non-Liability for Labor and Materials Furnished

BLM  
Date  
Stamp

RECEIVED  
M AZ STATE OFFICE  
2014 AUG 19 A 11:05  
PHOENIX, ARIZONA

LINE NO.	AMC NUMBER	CLAIM/SITE NAME	COUNTY RECORDER DATA (If available)	TWP	RNG	SEC
11	266964	Don Key #1	yav.	8N	3W	35
12	266965	Don Key #2	yav.	8N	3W	35
13	266966	Don Key #3	yav.	8N	3W	35
14	268020	Don Key #4	yav.	8N	3W	35
15	268021	Don Key #5	yav.	8N	3W	35
16	268022	Don Key #6	yav.	8N	3W	35
17	277387	Don Key #7	yav.	8N	3W	35
18	277388	Don Key #8	yav.	8N	3W	35
19	354048	Don Key #9	yav.	8N	3W	35
20	354049	Don Key #10	yav.	8N	3W	35
21	356328	Buzzard #1	yav.	7N	3W	12
22	356329	Buzzard #2	yav.	7N	3W	12
23	362141	Buzzard #3	yav.	7N	3W	12
24	351675	Select # 1	yav.	7N	3W	10
25	351676	Select # 2	yav.	7N	3W	10
26	351677	Select # 3	yav.	7N	3W	10
27	353269	Hog	yav.	8N	3W	36
28	363922	Old Mill #1	yav.	7N	3W	10
29	363923	Old mill #2	yav.	7N	3W	10

Form MCF114  
Revised June 2005

This form is available from the Arizona Department of Mines & Mineral Resources and may be reproduced.

**SUPPLEMENTAL ATTACHMENT**

May be used with the following forms for listing additional mining claims:

Check One.

- Affidavit of Performance of Annual Work
- Maintenance Fee Payment
- Notice of Intent to Hold Mining Claims
- Notice of Non-Liability for Labor and Materials Furnished

RECEIVED  
BLM AZ STATE OFFICE  
2014 AUG 19 A 11:05  
PHOENIX, ARIZONA

BLM  
Date  
Stamp

LINE NO.	AMC NUMBER	CLAIM/SITE NAME	COUNTY RECORDER DATA (If available)	TWP	RNG	SEC
30	355276	Brass King	Maricopa	7N	3W	21
31	363920	Cate law # 8	Maricopa	7N	3W	13
32	363921	Cate law # 9	Maricopa	7N	3W	13

Form MCF114  
Revised June 2005



**United States Department of the Interior**  
**Bureau of Land Management**  
 LANDS/RECREATION & PLANNING  
 ONE N CENTRAL AVE  
 PHOENIX, AZ 85004 -2203  
 Phone: 602-417-9200

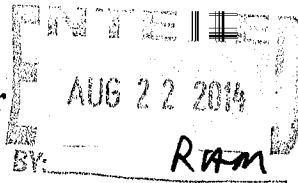

Receipt

No: 3105837

<b>Transaction #:</b> 3197101	
<b>Date of Transaction:</b> 08/19/2014	
<b>CUSTOMER:</b>	
BEVERLY BROWN 10502 W CHERRY TREE LN SUN CITY, AZ 85373-1024 US	

LINE #	QTY	DESCRIPTION	REMARKS	UNIT PRICE	TOTAL
1	1.00	LOCATABLE MINERALS / MINING CLAIMS- NOT NEW-UNADJUD, ONE AUTH NO. ONLY / MINING CLAIM MONEY RECEIVED CASES: AMC353844/\$4960.00	MAINT 2015/32	- n/a -	4960.00
<b>TOTAL:</b>					<b>\$4,960.00</b>

PAYMENT INFORMATION				
NOTE: Items will appear on credit card statement as "Bureau of Land Mgmt CO".				
1	AMOUNT:	2480.00	POSTMARKED: N/A	
	TYPE:	CASH	RECEIVED: 08/19/2014	
	NAME:	KINZENBAW, DAVID 10502 W CHERRY TREE LN SUN CITY AZ 85373-1024 US		
2	AMOUNT:	2480.00	POSTMARKED: N/A	
	TYPE:	CREDIT CARD	RECEIVED: 08/19/2014	
	NAME:	BROWN, BEVERLY 10502 W CHERRY TREE LN SUN CITY AZ 85373-1024 US		
	CARD NO:	XXXXXXXXXXXX3407	AUTH CODE: 08143B	
	NAME ON CARD:	BEVERLY M BROWN		
	EXPIRES:	03/2016		
	SIGNATURE:			

REMARKS
---------

This receipt was generated by the automated BLM Collections and Billing System and is a paper representation of a portion of the official electronic record contained therein.

# Lead file #s For B. Brown

353844

354046

355276

355354

355375

356328

358408

266964

268020

277387

354046

362141

351675

353269

363920

**MAINTENANCE FEE PAYMENT**

Claimant Name: Beverly Brown / David Kinzenbaw  
 Address: 10502 Cherry Tree LN  
 City: SUN City State: AZ Zip: 85373  
 Telephone: C. 623-512-6895 Dave C.  
 E-mail address: bevybrown@centurylink.com  
 Signature: Beverly Brown / David R Kinzenbaw

Check here if this is a change of address.

RECEIVED  
 BLM AZ STATE OFFICE  
 PHOENIX, ARIZONA  
 2013 AUG - 6 A 11: 47  
 BLM  
 Date  
 Stamp

LINE NO.	AMC NUMBER	CLAIM/SITE NAME	COUNTY RECORDER DATA (If available)	TWP	RNG	SEC
1 -	353844	Red Rooster	Maricopa	7N	3W	21
2	354046	Catclaw # 1	Maricopa	7N	3W	13
3 -	354047	Catclaw # 2	Maricopa	7N	3W	13
4 -	355277	Catclaw # 3	Maricopa	7N	3W	24
5 -	355354	Catclaw # 4	Maricopa	7N	3W	13
6	355375	Catclaw # 5	Maricopa	7N	3W	24
7	355376	Catclaw # 6	Maricopa	7N	3W	24
8 -	356330	Catclaw # 7	Maricopa	7N	3W	24
9	358409	Havelina # 1	Maricopa	7N	3W	22
10 -	358408	Havelina # 2	Maricopa	7N	3W	22

List additional claims on Form MCF114.

Bureau of Land Management  
 Arizona State Office  
 www.blm.gov/az/

No. of Claims: 32 x \$140 = 4,480  
 Check No.: CC 9098 Init. ML  
 Receipt No.: 2848381  
 For BLM Use Only

Form: MCF112  
 Revised July 2009

This form is available from the Arizona Department of Mines and Mineral Resources and may be reproduced.

**ENTERED INTO COMPUTER**  
 AUG 13 2013

**SUPPLEMENTAL ATTACHMENT**

May be used with the following forms for listing additional mining claims:

Check One.

- Affidavit of Performance of Annual Work
- Maintenance Fee Payment
- Notice of Intent to Hold Mining Claims
- Notice of Non-Liability for Labor and Materials Furnished

BLM  
Date  
Stamp

RECEIVED  
 BLM AZ STATE OFFICE  
 PHOENIX, ARIZONA  
 2013 AUG - 6 A 11:47

LINE NO.	AMC NUMBER	CLAIM/SITE NAME	COUNTY RECORDER DATA (If available)	TWP	RNG	SEC
11	266964	Don Key #1	yav.	8N	3W	35
12	266965	Don Key #2	yav.	8N	3W	35
13	266966	Don Key #3	yav.	8N	3W	35
14	268020	Don Key #4	yav.	8N	3W	35
15	268021	Don Key #5	yav.	8N	3W	35
16	268022	Don Key #6	yav.	8N	3W	35
17	277387	Don Key #7	yav.	8N	3W	35
18	277388	Don Key #8	yav.	8N	3W	35
19	354048	Don Key #9	yav.	8N	3W	35
20	354049	Don Key #10	yav.	8N	3W	35
21	356328	Buzzard #1	yav.	7N	3W	12
22	356329	Buzzard #2	yav.	7N	3W	12
23	362141	Buzzard #3	yav.	7N	3W	12
24	351675	Select #1	yav.	7N	3W	10
25	351676	Select #2	yav.	7N	3W	10
26	351677	Select #3	yav.	7N	3W	10
27	353219	Hog	yav.	8N	3W	36
28	363922	Old mill #1	yav.	7N	3W	10
29	363923	Old mill #2	yav.	7N	3W	10

Form MCF114  
Revised June 2005



**United States Department of the Interior**  
**Bureau of Land Management**  
 LANDS/RECREATION & PLANNING  
 ONE N CENTRAL AVE  
 PHOENIX, AZ 85004 -2203  
 Phone: 602-417-9200

Receipt

No: 2848381

**Transaction #:** 2934077

**Date of Transaction:** 08/06/2013

**CUSTOMER:**

BEVERLY BROWN  
 10502 W CHERRY TREE LN  
 SUN CITY, AZ 85373-1024 US

LINE #	QTY	DESCRIPTION	REMARKS	UNIT PRICE	TOTAL
1	1.00	LOCATABLE MINERALS / MINING CLAIMS-NOT NEW-UNADJUD, ONE AUTH NO. ONLY / MINING CLAIM MONEY RECEIVED CASES: AMC353844/\$4480.00	MAINT 2014/32	- n/a -	4480.00
<b>TOTAL:</b>					<b>\$4,480.00</b>

**PAYMENT INFORMATION**

NOTE: Items will appear on credit card statement as "Bureau of Land Mgmt CO".

1	AMOUNT:	2240.00	POSTMARKED:	N/A
	TYPE:	CASH	RECEIVED:	08/06/2013
	NAME:	KINZENBAW, DAVID 13047 N 19TH ST PHOENIX AZ 85022 US		
2	AMOUNT:	2240.00	POSTMARKED:	N/A
	TYPE:	CREDIT CARD	RECEIVED:	08/06/2013
	NAME:	BROWN, BEVERLY 10502 W CHERRY TREE LN SUN CITY AZ 85373-1024 US		
	CARD NO:	XXXXXXXXXXXX8512	AUTH CODE:	01714C
	NAME ON CARD:	BEVERLY M BROWN		
	EXPIRES:	06/2015		
	SIGNATURE:			

**REMARKS**

This receipt was generated by the automated BLM Collections and Billing System and is a paper representation of a portion of the official electronic record contained therein.

Amc 353844  
 353269  
 351675  
 354046  
 355276  
 355354

Amc 355375  
 356328  
 358408  
 362141  
 363920

**MAINTENANCE FEE PAYMENT**

Claimant Name: Beverly Brown / David Kinzenbaw  
 Address: 10502 Cherry Tree LN  
 City: Sun City State: AZ Zip: 85373  
 Telephone: H 623-972-0057 - C. 623 512 6895  
 E-mail address: bevbrown@centurylink.net  
 Signature: Beverly Brown / David R. Kinzenbaw

RECEIVED  
 BLM AZ STATE OFFICE  
 2012 AUG - 7 A 10:47  
 PHOENIX, ARIZONA  
 BLM  
 Date  
 Stamp

Check here if this is a change of address.

LINE NO.	AMC NUMBER	CLAIM/SITE NAME	COUNTY RECORDER DATA (If available)	TWP	RNG	SEC
1	353844	Red Rooster	Maricopa	7N	3W	21
2	354046	Catclaw # 1	Maricopa	7N	3W	13
3	354047	Catclaw # 2	Maricopa	7N	3W	13
4	355277	Catclaw # 3	Maricopa	7N	3W	24
5	355354	Catclaw # 4	Maricopa	7N	3W	13
6	355375	Catclaw # 5	Maricopa	7N	3W	24
7	355376	Catclaw # 6	Maricopa	7N	3W	24
8	356330	Catclaw # 7	Maricopa	7N	3W	24
9	358409	Havelina # 1	Maricopa	7N	3W	22
10	358408	Havelina # 2	Maricopa	7N	3W	22

List additional claims on Form MCF114.

No. of Claims: 22 x \$140 = 3,080  
 Check No: CC & Cash thit. AME  
 Receipt No.: 2624523  
 For BLM Use Only

Bureau of Land Management  
 Arizona State Office  
 www.blm.gov/az/

Form: MCF112  
 Revised July 2009

This form is available from the Arizona Department of Mines and Mineral Resources and may be reproduced.

ENTERED INTO COMPUTER

8/21/12 AT



**SUPPLEMENTAL ATTACHMENT**

May be used with the following forms for listing additional mining claims:

Check One.

- Affidavit of Performance of Annual Work
- Maintenance Fee Payment
- Notice of Intent to Hold Mining Claims
- Notice of Non-Liability for Labor and Materials Furnished

RECEIVED  
 BLM AZ STATE OFFICE  
 2012 AUG - 7 A 10:47  
 PHOENIX, ARIZONA  
 BLM  
 Date  
 Stamp

LINE NO.	AMC NUMBER	CLAIM/SITE NAME	COUNTY RECORDER DATA (If available)	TWP	RNG	SEC
11	356328	Buzzard#1	yav.	7N	3W	12
12	356329	Buzzard#2	yav.	7N	3W	12
13	362141	Buzzard#3	yav.	7N	3W	12
14	351675	Select#1	yav.	7N	3W	10
15	351676	Select#2	yav.	7N	3W	10
16	351677	Select#3	yav.	7N	3W	10
17	353269	Hog	yav.	8N	3W	36
18	363922	Old Mill#1	yav.	7N	3W	10
19	363923	Old Mill#2	yav.	7N	3W	10
20	355276	Brass Ring	Maricopa	7N	3W	21
21	363920	Catclaw#8	Maricopa	7N	3W	13
22	363921	Catclaw#9	Maricopa	7N	3W	13

Form MCF114  
 Revised June 2005

United States Department of the Interior  
 Bureau of Land Management  
 LANDS/RECREATION & PLANNING  
 ONE N CENTRAL AVE  
 PHOENIX, AZ 85004 -2203  
 Phone: 602-417-9200



Receipt

No:

2624523

<b>Transaction #:</b> 2704920	
<b>Date of Transaction:</b> 08/07/2012	
<b>CUSTOMER:</b>	
BEVERLY BROWN 10502 W CHERRY TREE LN SUN CITY, AZ 85373-1024 US	

LINE #	QTY	DESCRIPTION	REMARKS	UNIT PRICE	TOTAL
1	1.00	LOCATABLE MINERALS / MINING CLAIMS-NOT NEW-UNADJUD, ONE AUTH NO. ONLY / MINING CLAIM MONEY RECEIVED CASES: AMC353844/\$3080.00	Mount 2013/22	- n/a -	3080.00
<b>TOTAL:</b>					<b>\$3,080.00</b>

PAYMENT INFORMATION			
NOTE: Items will appear on credit card statement as "Bureau of Land Mgmt CO".			
1	AMOUNT:	1540.00	POSTMARKED: N/A
	TYPE:	CASH	RECEIVED: 08/07/2012
	NAME:	KINZENBAW, DAVID 13047 N 19TH ST PHOENIX AZ 85022 US	
2	AMOUNT:	1540.00	POSTMARKED: N/A
	TYPE:	CREDIT CARD	RECEIVED: 08/07/2012
	NAME:	BROWN, BEVERLY 10502 W CHERRY TREE LN SUN CITY AZ 85373-1024 US	
	CARD NO:	XXXXXXXXXXXX8512	AUTH CODE: 04732C
	NAME ON CARD:	BEVERLY M BROWN	
	EXPIRES:	06/2015	
	SIGNATURE:		

REMARKS

This receipt was generated by the automated BLM Collections and Billing System and is a paper representation of a portion of the official electronic record contained therein. Lead Amc #s (28)

Amc 353844      Amc 356328      Amc 363920  
 354046      358408  
 355276      362141  
 355354      351675  
 355375      353269

AMC 355276  
 AMC 363920  
 AMC 353269  
 AMC 351675  
 AMC 362141  
 AMC 358408

AMC 353844  
 AMC 354046  
 AMC 355276  
 AMC 355354  
 AMC 355375  
 AMC 356328

**MAINTENANCE FEE PAYMENT**

Claimant Name: Beverly Brown/David Katzenbaw  
 Address: 10502 Cherry Tree Ln.  
 City: SAN CITY State: AZ Zip: 85373  
 Telephone: 480-972-0057 C. 623 512 6895  
 E-mail address: \_\_\_\_\_  
 Signature: Beverly Brown  
 Check here if this is a change of address.

RECEIVED  
 ARIZONA STATE OFFICE  
 2011 AUG 23 A 10:53  
 HOEHIK, ARIZONA  
 BLM  
 Date  
 Stamp

LINE NO.	AMC NUMBER	CLAIM/SITE NAME	COUNTY RECORDER DATA (If available)	TWP	RNG	SEC
1	353844	Red Rooster	Maricopa	7N	3W	21
2	354046	Catclaw #1	Maricopa	7N	3W	13
3	354047	Catclaw #2	Maricopa	7N	3W	13
4	355277	Catclaw #3	Maricopa	7N	3W	24
5	355354	Catclaw #4	Maricopa	7N	3W	13
6	355375	Catclaw #5	Maricopa	7N	3W	24
7	355376	Catclaw #6	Maricopa	7N	3W	24
8	356330	Catclaw #7	Maricopa	7N	3W	24
9	358409	Havelina #1	Maricopa	7N	3W	22
10	358408	Havelina #2	Maricopa	7N	3W	22

List additional claims on Form MCF114.

No. of Claims: 22 x \$140 = 3,080  
 Check No: CC # cash Init. MBL  
 Receipt No.: 2412709  
 For BLM Use Only

Bureau of Land Management  
 Arizona State Office  
 www.blm.gov/az/

SEP 1 2011  
 Cm

Form: MCF112  
 Revised July 2009

This form is available from the Arizona Department of Mines and Mineral Resources and may be reproduced.

**SUPPLEMENTAL ATTACHMENT**

May be used with the following forms for listing additional mining claims:

Check One.

- Affidavit of Performance of Annual Work
- Maintenance Fee Payment
- Notice of Intent to Hold Mining Claims
- Notice of Non-Liability for Labor and Materials Furnished

BLM  
Date  
Stamp

2011 AUG 23 A 10:53  
PHOENIX, ARIZONA

RECEIVED

LINE NO.	AMC NUMBER	CLAIM/SITE NAME	COUNTY RECORDER DATA (If available)	TWP	RNG	SEC
11	356328	Buzzard #1	yav.	7N	3W	12
12	356329	Buzzard #2	yav.	7N	3W	12
13	362141	Buzzard #3	yav.	7N	3W	12
14	351675	Select #1	yav.	7N	3W	10
15	351676	Select #2	yav.	7N	3W	10
16	351677	Select #3	yav.	7N	3W	10
17	353269	Hog	yav.	8N	3W	36
18	363922	Old mill #1	yav.	7N	3W	10
19	363923	Old mill #2	yav.	7N	3W	10
20	355276	Brass Ring	Maricopa	7N	3W	21
21	363920	Catclaw #8	Maricopa	7N	3W	13
22	363921	Catclaw #9	Maricopa	7N	3W	13

Form MCF114  
Revised June 2005

**United States Department of the Interior**  
**Bureau of Land Management**  
 LANDS/RECREATION & PLANNING  
 ONE N CENTRAL AVE  
 PHOENIX, AZ 85004 -2203  
 Phone: 602-417-9200

Receipt

No: 2412707

<b>Transaction #:</b> 2488058	
<b>Date of Transaction:</b> 08/23/2011	
<b>CUSTOMER:</b>	
BEVERLY BROWN 10502 W CHERRY TREE LN SUN CITY, AZ 85373-1024 US	

LINE #	QTY	DESCRIPTION	REMARKS	UNIT PRICE	TOTAL
1	1.00	LOCATABLE MINERALS / MINING CLAIMS-NOT NEW-UNADJUD, ONE AUTH NO. ONLY / MINING CLAIM MONEY RECEIVED CASES: AMC353844/\$3080.00	MAINT 2012/22	- n/a -	3080.00
<b>TOTAL:</b>					<b>\$3,080.00</b>

PAYMENT INFORMATION					
NOTE: Items will appear on credit card statement as "Bureau of Land Mgmt CO".					
1	AMOUNT:	1540.00	POSTMARKED:	N/A	
	TYPE:	CASH	RECEIVED:	08/23/2011	
	NAME:	KIZENBAW, DAVID 13047 N 19TH ST PHOENIX AZ 85022 US			
2	AMOUNT:	1540.00	POSTMARKED:	N/A	
	TYPE:	CREDIT CARD	RECEIVED:	08/23/2011	
	NAME:	BROWN, BEVERLY 10502 W CHERRY TREE LN SUN CITY AZ 85373-1024 US			
	CARD NO:	XXXXXXXXXXXX5819	AUTH CODE:	02015C	
	NAME ON CARD:	BEVERLY M BROWN			
	EXPIRES:	06/2012			
	SIGNATURE:				

REMARKS

This receipt was generated by the automated BLM Collections and Billing System and is a paper representation of a portion of the official electronic record contained therein.

Receipt: 2191433

AMC	353844
AMC	354046
AMC	355276
AMC	355375
AMC	355354
AMC	356328
AMC	358408
AMC	362141
AMC	351675
AMC	353269
AMC	363920

~~AMC 353844~~  
~~AMC 354046~~  
~~AMC 355276~~  
~~AMC 355375~~  
~~AMC 355354~~  
~~AMC 356328~~

**MAINTENANCE FEE PAYMENT**

Claimant Name: Beverly Brown/David Kinzenbaw  
 Address: 10502 Cherry Tree Ln.  
 City: SUN CITY State: AZ Zip: 85373 ✓  
 Telephone: 623-972-0057  
 E-mail address: \_\_\_\_\_  
 Signature: Beverly Brown

Check here if this is a change of address.

RECEIVED  
 BLM AZ STATE OFFICE  
 PHOENIX, ARIZONA  
 2010 AUG 16 A 10:59  
 BLM Date Stamp

LINE NO.	AMC NUMBER	CLAIM/SITE NAME	COUNTY RECORDER DATA (If available)	TWP	RNG	SEC
1	353844	Red Rooster	Maricopa ✓			
2	354046	Catclaw #1	Maricopa			
3	354047	Catclaw #2	Maricopa			
4	355277	Catclaw #3	Maricopa			
5	355354	Catclaw #4	Maricopa			
6	355375	Catclaw #5	Maricopa			
7	355376	Catclaw #6	Maricopa			
8	356330	Catclaw #7	Maricopa			
9	358409	Havalina #1	Maricopa			
10	358408	Havalina #2	Maricopa			

List additional claims on Form MCF114.

No. of Claims: 22 x \$140 = 3,080  
 Check No: CASH Init. JC  
 Receipt No.: 2191433  
 For BLM Use Only

Bureau of Land Management  
 Arizona State Office  
 www.blm.gov/az/

Form: MCF112  
 Revised July 2009

This form is available from the Arizona Department of Mines and Mineral Resources and may be reproduced.

10/50

CC 1,540  
 1,540  
 3,080





**United States Department of the Interior**  
**Bureau of Land Management**  
 LANDS/RECREATION & PLANNING  
 ONE N CENTRAL AVE  
 PHOENIX, AZ 85004 -2203  
 Phone:

Receipt

No: 2191433

<b>Transaction #:</b> 2261191	<b>ENTERED INTO COMPUTER</b>
<b>Date of Transaction:</b> 08/16/2010	
<b>CUSTOMER:</b> BEVERLY BROWN 10502 W CHERRY TREE LN SUN CITY, AZ 85373-1024 US	AUG 24 2010 ✓

LINE #	QTY	DESCRIPTION	REMARKS	UNIT PRICE	TOTAL
1	1.00	LOCATABLE MINERALS / MINING CLAIMS-NOT NEW-UNADJUD, ONE AUTH NO. ONLY / MINING CLAIM MONEY RECEIVED CASES: AMC353844/\$3080.00	MAINT (22) 2011	- n/a -	3080.00
<b>TOTAL:</b>					<b>\$3,080.00</b>

**PAYMENT INFORMATION**

NOTE: Items will appear on credit card statement as "Bureau of Land Mgmt CO".

1	AMOUNT:	1540.00	POSTMARKED:	N/A
	TYPE:	CASH	RECEIVED:	08/16/2010
	NAME:	BROWN, BEVERLY 10502 W CHERRY TREE LN SUN CITY AZ 85373-1024 US		
2	AMOUNT:	1540.00	POSTMARKED:	N/A
	TYPE:	CREDIT CARD	RECEIVED:	08/16/2010
	NAME:	BROWN, BEVERLY 10502 W CHERRY TREE LN SUN CITY AZ 85373-1024 US		
	CARD NO:	XXXXXXXXXXXX2786	AUTH CODE:	07634B
	NAME ON CARD:	BEVERLY BROWN		
	EXPIRES:	05/2012		
	SIGNATURE:			

**REMARKS**

This receipt was generated by the automated BLM Collections and Billing System and is a paper representation of a portion of the official electronic record contained therein.

AMC 363920 AMC 353844  
 AMC 354046  
 AMC 355276  
 AMC 355354  
 AMC 355375  
 AMC 356328  
 AMC 358408  
 AMC 362141  
 AMC 351675  
 AMC 353269

**MAINTENANCE FEE PAYMENT**

Claimant Name: Beverly Brown / David Kinzenbaw  
 Address: 10502 Cherry Tree Ln.  
 City: SUN City State: AZ Zip: 85373  
 Telephone: 623 972-0057  
 E-mail address: \_\_\_\_\_  
 Signature: Beverly Brown  
 Check here if this is a change of address.

RECEIVED  
 B.L.M. AZ STATE OFFICE  
 2008 AUG 12 A 10: 34  
 PHOENIX, ARIZONA  
 BLM  
 Date  
 Stamp

LINE NO.	AMC NUMBER	CLAIM/SITE NAME	COUNTY RECORDER DATA (If available)	TWP	RNG	SEC
1	353844	Red Rooster	Maricopa	7N	3W	21
2	354046	Catclaw #1	Maricopa	7N	3W	13
3	354047	Catclaw #2	Maricopa	7N	3W	13
4	355277	Catclaw #3	Maricopa	7N	3W	24
5	355354	Catclaw #4	Maricopa	7N	3W	13
6	355375	Catclaw #5	Maricopa	7N	3W	24
7	355376	Catclaw #6	Maricopa	7N	3W	24
8	356330	Catclaw #7	Maricopa	7N	3W	24
9	358409	Havelina #1	Maricopa	7N	3W	22
10	358408	Havelina #2	Maricopa	7N	3W	22

List additional claims on Form MCF114.

Bureau of Land Management  
 Arizona State Office  
[www.az.blm.gov](http://www.az.blm.gov)

No. of Claims: 22 x \$125 = 2,750  
 Check No: Cash & ck 4000 nit. MC  
 Receipt No. 1759109  
 For BLM Use Only

Form: MCF112  
 Revised July 2005

This form is available from the Arizona Department of Mines and Mineral Resources and may be reproduced.

ENTERED INTO COMPUTER

SEP 03 '08

**SUPPLEMENTAL ATTACHMENT**

May be used with the following forms for listing additional mining claims:

Check One.

- Affidavit of Performance of Annual Work
- Maintenance Fee Payment
- Notice of Intent to Hold Mining Claims
- Notice of Non-Liability for Labor and Materials Furnished

RECEIVED  
BLM. AZ STATE OFFICE  
2008 AUG 12 A 10:30  
PHOENIX, ARIZONA  
BLM  
Date  
Stamp

LINE NO.	AMC NUMBER	CLAIM/SITE NAME	COUNTY RECORDER DATA (If available)	TWP	RANGE	SEC
11	356328	Buzzard#1	yav.	7N	3W	12
12	356329	Buzzard#2	yav.	7N	3W	12
13	362141	Buzzard#3	yav.	7N	3W	12
14	351675	Select #1	yav.	7N	3W	10
15	351676	Select #2	yav.	7N	3W	10
16	351677	Select#3	yav.	7N	3W	10
17	353269	Hog	yav.	8N	3W	36
18	363922	Old Mill #1	yav.	7N	3W	10
19	363923	Old Mill #2	yav.	7N	3W	10
20	355276	Brass Ring	maricopa	7N	3W	21
21	363920	Catclaw#8	maricopa	7N	3W	13
22	363921	Catclaw#9	maricopa	7N	3W	13

Form MCF114  
Revised June 2005

This form is available from the Arizona Department of Mines & Mineral Resources and may be reproduced.

United States Department of the Interior

Bureau of Land Management  
 BUSINESS & SUPPORT SVCS DIV  
 ONE N CENTRAL AVE SUITE 800  
 PHOENIX, AZ 85004 -4427  
 Phone: (602) 417-9200

Receipt

No:

1759109

<b>Transaction #:</b> 1816595	
<b>Date of Transaction:</b> 08/12/2008	
<b>CUSTOMER:</b>	DAVID KINZENBAW BEVERLY BROWN 10502 CHERRY TREE LN SUN CITY, AZ 85373

LINE #	QTY	DESCRIPTION	REMARKS	UNIT PRICE	TOTAL
1	1.00	LOCATABLE MINERALS / MINING CLAIMS-NOT NEW-UNADJUD, ONE AUTH NO. ONLY / MINING CLAIM MONEY RECEIVED (455) CASES: AMC353844/\$2750.00	MAINT 2009/22	- n/a -	2750.00
<b>TOTAL:</b>					<b>\$2,750.00</b>

PAYMENT INFORMATION			
1	AMOUNT:	\$1,375.00	POSTMARKED: N/A
	TYPE:	CASH	RECEIVED: 08/12/2008
	NAME:	BEVERLY BROWN KINZENBAW, DAVID 10502 CHERRY TREE LN SUN CITY AZ 85373	
2	AMOUNT:	\$1,375.00	POSTMARKED: N/A
	TYPE:	CHECK	RECEIVED: 08/12/2008
	CHECK NO:	4070	
	NAME:	BEVERLY BROWN KINZENBAW, DAVID 10502 CHERRY TREE LN SUN CITY AZ 85373	

REMARKS

This receipt was generated by the automated BLM Collections and Billing System and is a paper representation of a portion of the official electronic record contained therein.

LEAD FILE NUMBERS:

AMC 353844	356328	363920
354046	362141	
355276	351675	
355354	353269	
355375	362917	
356328	363923	
358408	355276	

LEAD AMC SERIAL NUMBER	AMC SERIAL NUMBER(S)	NUMBER OF CLAIM(S)
353844		1
354046	354047, 46	2
355276	355277	2
355354		1
355375	355376, 75	2
356328	356330	1
358408	358408, 09	2
356328	356328, 29	2
362141		1
351675	351675, 76, 77	3
353269		1
362917	363922	1
363923		1
355276		#
363920	363920	2
<del>363921</del>		

ENTERED INTO COMPUTER

8/21/07 DJJ

AMC 353844  
 354046  
 355276  
 356328  
 358408  
 356328

**MAINTENANCE FEE PAYMENT**

Claimant Name: Beverly Brown / David Kizenbau  
 Address: 10502 Cherry Tree Ln  
 City: SUN City State: AZ Zip: 85373  
 Telephone: 623-972-0057  
 E-mail address: \_\_\_\_\_  
 Signature: Beverly Brown

Check here if this is a change of address.

RECEIVED  
 BLM, AZ STATE OFFICE  
 2007 AUG 13 A 10:46  
 PHOENIX, ARIZONA  
 BLM  
 Date  
 Stamp

LINE NO.	AMC NUMBER	CLAIM/SITE NAME	COUNTY RECORDER DATA (If available)	TWP	RNG	SEC
1	353 844	Red Rooster	Maricopa	7N	3W	21
2 L	354 046	Catclaw #1	Maricopa	7N	3W	13
3 L	354 047	Catclaw #2	Maricopa	7N	3W	13
4	355 277	Catclaw #3	Maricopa	7N	3W	24
5 L	355 354	Catclaw #4	Maricopa	7N	3W	13
6 L	355 375	Catclaw #5	Maricopa	7N	3W	24
7 "	355 376	Catclaw #6	Maricopa	7N	3W	24
8	356 330	Catclaw #7	Maricopa	7N	3W	24
9	358 409	Havalina #1	Maricopa	7N	3W	22
10	358 408	Havalina #2	Maricopa	7N	3W	22

List additional claims on Form MCF114.

Bureau of Land Management  
 Arizona State Office  
[www.az.blm.gov](http://www.az.blm.gov)

No. of Claims: 22 x \$125 = 2,750  
 Check No: CC & Cash Unit: AMC  
 Receipt No.: 154278  
 For BLM Use Only

Form: MCF112  
 Revised July 2005

This form is available from the Arizona Department of Mines and Mineral Resources and may be reproduced.

**SUPPLEMENTAL ATTACHMENT**

May be used with the following forms for listing additional mining claims:

Check One.

- Affidavit of Performance of Annual Work
- Maintenance Fee Payment
- Notice of Intent to Hold Mining Claims
- Notice of Non-Liability for Labor and Materials Furnished

RECEIVED  
 BLM, AZ STATE OFFICE  
 2007 AUG 13 A 10:46  
 PHOENIX, ARIZONA  
 BLM  
 Date  
 Stamp

LINE NO.	AMC NUMBER	CLAIM/SITE NAME	COUNTY RECORDER DATA (If available)	TWP	RNG	SEC
L 11	356328	Buzzard #1	yav.	7N	3W	12
" 12	356329	Buzzard #2	yav.	7N	3W	12
L 13	362141	Buzzard #3	yav.	7N	3W	12
L 14	351675	Select #1	yav.	7N	3W	10
" 15	351676	Select #2	yav.	7N	3W	10
" 16	351677	Select #3	yav.	7N	3W	10
L 17	353269	Hog	yav.	8N	3W	36
362917 L 18	363922	Old mill #1	yav.	7N	3W	10
L 19	363923	Old mill #2	yav.	7N	3W	10
L 20	355276	Brass Ring	Maricopa	7N	3W	21
L 21	363920	Catclaw #8	Maricopa	7N	3W	13
" 22	363921	Catclaw #9	Maricopa	7N	3W	13

Form MCF114  
 Revised June 2005

**United States Department of the Interior**  
**Bureau of Land Management**  
 BUSINESS & SUPPORT SVCS DIV  
 ONE N CENTRAL AVE SUITE 800  
 PHOENIX, AZ 85004 -4427  
 Phone: (602) 417-9200

Receipt

No: 1542178

<b>Transaction #:</b> 1593527	
<b>Date of Transaction:</b> 08/13/2007	
<b>CUSTOMER:</b>	BEVERLY BROWN DAVID KIZENBAW 10502 CHERRY TREE LN SUN CITY, AZ 85373

LINE #	QTY	DESCRIPTION	REMARKS	UNIT PRICE	TOTAL
1	1.00	LOCATABLE MINERALS / MINING CLAIMS- NOT NEW-UNADJUD, ONE AUTH NO. ONLY / MINING CLAIM MONEY RECEIVED (455) CASES: AMC353844/\$2750.00	<i>Can 22</i>	- n/a -	2750.00
<b>TOTAL:</b>					<b>\$2,750.00</b>

PAYMENT INFORMATION			
NOTE: Items will appear on credit card statement as "Bureau of Land Management".			
1	AMOUNT:	\$1,375.00	POSTMARKED: N/A
	TYPE:	CASH	RECEIVED: 08/13/2007
	NAME:	DAVID KIZENBAW BROWN, BEVERLY 10502 CHERRY TREE LN SUN CITY AZ 85373	
2	AMOUNT:	\$1,375.00	POSTMARKED: N/A
	TYPE:	CREDIT CARD	RECEIVED: 08/13/2007
	NAME:	DAVID KIZENBAW BROWN, BEVERLY 10502 CHERRY TREE LN SUN CITY AZ 85373	
	CARD NO:	XXXXXXXXXXXX2786	AUTH CODE: 00052Z
	NAME ON CARD:	BEVERLY M BROWN	
	EXPIRES:	04/30/2009	
	SIGNATURE:		



AMC 351675      354046      355375      362141  
 353269      355276      356328      363920  
 353844      **355354**      358408

**MAINTENANCE FEE PAYMENT**

Claimant Name: Beverly Brown / David Kinzenbaw  
 Address: 10502 Cherry Tree LN  
 City: Sun City State: AZ Zip: 85373  
 Telephone: 623-972-0057  
 E-mail address: \_\_\_\_\_  
 Signature: Beverly Brown

RECEIVED  
 B.L.M. AZ STATE OFFICE  
 2006 AUG - 8 A 11: 07  
 PHOENIX, ARIZONA  
 BLM  
 Date  
 Stamp

Check here if this is a change of address.

LINE NO.	AMC NUMBER	CLAIM/SITE NAME	COUNTY RECORDER DATA (If available)	TWP	RNG	SEC
1	353844	Red Rooster	Maricopa	7N	3W	21
2	354046	Catclaw #1	Maricopa	7N	3W	13
3	354047	Catclaw #2	Maricopa	7N	3W	13
4	355277	Catclaw #3	Maricopa	7N	3W	24
5	355354	Catclaw #4	Maricopa	7N	3W	13
6	355375	Catclaw #5	Maricopa	7N	3W	24
7	355376	Catclaw #6	Maricopa	7N	3W	24
8	356330	Catclaw #7	Maricopa	7N	3W	24
9	358409	Havalina #1	Maricopa	7N	3W	22
10	358408	Havalina #2	Maricopa	7N	3W	22

List additional claims on Form MCF114.

Bureau of Land Management  
 Arizona State Office  
[www.az.blm.gov](http://www.az.blm.gov)

No. of Claims: 22 x \$125 = 2,750 -  
 Check No.: #3644/cash Unit. YMC  
 Receipt No.: 1329770  
 For BLM Use Only

Form: MCF112  
 Revised July 2005

This form is available from the Arizona Department of Mines and Mineral Resources and may be reproduced.

**ENTERED INTO COMPUTER**  
 AUG 11 2006 PB





**United States Department of the Interior**  
**Bureau of Land Management**  
 BUSINESS & SUPPORT SVCS DIV  
 ONE N CENTRAL AVE  
 PHOENIX, AZ 85004 -2203  
 Phone: (602) 417-9200

Receipt

No: 1329770

<b>Transaction #:</b> 1374773	<b>ENTERED INTO COMPUTER</b> AUG 11 2006 PB
<b>Date of Transaction:</b> 08/08/2006	
<b>CUSTOMER:</b> BEVERLY BROWN DAVID KINZENBAW 10502 CHERRY TREE LN SUN CITY, AZ 85373	

LINE #	QTY	DESCRIPTION	REMARKS	UNIT PRICE	TOTAL
1	1.00	LOCATABLE MINERALS / MINING CLAIMS-NOT NEW-UNADJUD, ONE AUTH NO. ONLY / MINING CLAIM MONEY RECEIVED (455) CASES: AMC353844/\$2750.00	MAINT 2007/22	- n/a -	2750.00
<b>TOTAL:</b>					<b>\$2,750.00</b>

PAYMENT INFORMATION					
1	AMOUNT:	\$1,375.00	POSTMARKED:	N/A	
	TYPE:	CASH	RECEIVED:	08/08/2006	
	NAME:	DAVID KINZENBAW BROWN, BEVERLY 10502 CHERRY TREE LN SUN CITY AZ 85373			
2	AMOUNT:	\$1,375.00	POSTMARKED:	N/A	
	TYPE:	CHECK	RECEIVED:	08/08/2006	
	CHECK NO:	3644			
	NAME:	DAVID KINZENBAW BROWN, BEVERLY 10502 CHERRY TREE LN SUN CITY AZ 85373			

REMARKS

This receipt was generated by the automated BLM Collections and Billing System and is a paper representation of a portion of the official electronic record contained therein.

**United States Department of the Interior**  
**Bureau of Land Management**  
 BUSINESS & SUPPORT SVCS DIV  
 222 N CENTRAL AVE  
 PHOENIX, AZ 85004 -2203  
 Phone: (602) 417-9200

Receipt	
No:	1141627

<b>Transaction #:</b> 1180866	AMC 266964
<b>Date of Transaction:</b> 08/30/2005	AMC 268020
<b>CUSTOMER:</b> BEVERLY M BROWN	AMC 277387
10502 CHERRY TREE LN	AMC 354046
SUN CITY, AZ 85373	AMC 356328
	AMC 362141

AMC 353844  
 AMC 355354  
 AMC 355375  
 AMC 358408  
 AMC 351675  
 AMC 353269  
 AMC 363920

LINE #	QTY	DESCRIPTION	REMARKS	UNIT PRICE	TOTAL
1	1.00	LOCATABLE MINERALS / MINING CLAIMS-NOT NEW-UNADJUD, ONE AUTH NO. ONLY / MINING CLAIM MONEY RECEIVED (455) CASES: AMC266964/\$4000.00	MAINT 2006/32	- n/a -	4000.00
<b>TOTAL:</b>					<b>\$4,000.00</b>

RE 9/14/05

## PAYMENT INFORMATION

NOTE: Items will appear on credit card statement as "Bureau of Land Management".

1	AMOUNT:	\$1,665.00	POSTMARKED:	N/A
	TYPE:	CREDIT CARD	RECEIVED:	08/30/2005
	NAME:	BROWN, BEVERLY M 10502 CHERRY TREE LN SUN CITY AZ 85373		
	CARD NO:	XXXXXXXXXXXX2786	AUTH CODE:	008232
	NAME ON CARD:	BROWN/BEVERLY		
	EXPIRES:	04/30/2008		
	SIGNATURE:			
2	AMOUNT:	\$1,335.00	POSTMARKED:	N/A
	TYPE:	CHECK	RECEIVED:	08/30/2005
	CHECK NO:	3467		
	NAME:	BROWN, BEVERLY M 10502 CHERRY TREE LN SUN CITY AZ 85373		
3	AMOUNT:	\$1,000.00	POSTMARKED:	N/A
	TYPE:	CHECK	RECEIVED:	08/30/2005
	CHECK NO:	1001		
	NAME:	BROWN, BEVERLY M 10502 CHERRY TREE LN SUN CITY AZ 85373		

## REMARKS

This receipt was generated by the automated BLM Collections and Billing System and is a paper representation of a portion of the official electronic record contained therein.

**MAINTENANCE FEE PAYMENT**

Claimant Name: Beverly Brown  
 Address: 10502 Cherry Tree Ln.  
 City: Sun City State: AZ Zip: 85373  
 Telephone: 623 972 0057  
 E-mail address: \_\_\_\_\_  
 Signature: Beverly Brown

Check here if this is a change of address.

RECEIVED  
 B.L.M. AZ STATE OFFICE  
 PHOENIX, ARIZONA  
 2005 AUG 30 P 2:37  
 BLM  
 Date  
 Stamp

LINE NO.	AMC NUMBER	CLAIM/SITE NAME	COUNTY RECORDER DATA (If available)	TWP	RNG	SEC
1	266 964	DONKEY #1	yav.	8N	3W	35
2	266 965	DONKEY #2	yav.	8N	3W	35
3	266 966	DONKEY #3	yav.	8N	3W	35
4	268 020	DONKEY #4	yav.	8N	3W	35
5	268 021	DONKEY #5	yav.	8N	3W	35
6	268 022	DONKEY #6	yav.	8N	3W	35
7	277 387	DONKEY #7	yav.	8N	3W	35
8	277 388	DONKEY #8	yav.	8N	3W	35
9	354 048	DONKEY #9	yav.	8N	3W	35
10	354. 049	DONKEY #10	yav.	8N	3W	35

List additional claims on Form MCF114.

Bureau of Land Management  
 Arizona State Office  
[www.az.blm.gov](http://www.az.blm.gov)

No. of Claims: 19 x \$125 = 2,375  
 Check No: CR #3467 Init. TMC  
 #1001 E CC 1141627  
 Receipt No.: \_\_\_\_\_  
 For BLM Use Only

Form: MCF112  
 Revised July 2005

This form is available from the Arizona Department of Mines and Mineral Resources and may be reproduced.

RE 9/14/05

**SUPPLEMENTAL ATTACHMENT**

May be used with the following forms for listing additional mining claims:

Check One.

- Affidavit of Performance of Annual Work
- Maintenance Fee Payment
- Notice of Intent to Hold Mining Claims
- Notice of Non-Liability for Labor and Materials Furnished

BLM Date Stamp	RECEIVED B.M. AZ STATE OFFICE 2005 AUG 30 P 2:37 PHOENIX, ARIZONA
----------------------	----------------------------------------------------------------------------

LINE NO.	AMC NUMBER	CLAIM/SITE NAME	COUNTY RECORDER DATA (If available)	TWP	RNG	SEC
11	356 328	Buzzard #1	Yav.	7N	3W	12
12	356 329	Buzzard #2	Yav.	7N	3W	12
13	362 141	Buzzard #3	Yav.	7N	3W	12
14	351 675	Select # 1	Yav.	7N	3W	10
15	351 676	Select # 2	Yav.	7N	3W	10
16	351 677	Select # 3	Yav.	7N	3W	10
17	353 269	Hog	Yav.	8N	3W	36
18	363 922	Old Mill #1	Yav.	7N	3W	10
19	363 923	Old Mill #2	Yav.	7N	3W	10

Form MCF114  
Revised June 2005

This form is available from the Arizona Department of Mines & Mineral Resources and may be reproduced.

RE 9/17/05



**MAINTENANCE FEE PAYMENT**

Claimant Name: Beverly Brown / David Kinzenbaw  
 Address: 10502 Cherry Tree LN  
 City: SUN CITY State: AZ Zip: 85373  
 Telephone: 623-912-0057  
 E-mail address: \_\_\_\_\_  
 Signature: Beverly Brown

RECEIVED  
 B.L.M. AZ STATE OFFICE  
 2005 AUG 30 P 2:38  
 PHOENIX, ARIZONA  
 BLM  
 Date  
 Stamp

Check here if this is a change of address.

LINE NO.	AMC NUMBER	CLAIM/SITE NAME	COUNTY RECORDER DATA (if available)	TWP	RNG	SEC
1	353844	RED ROOSTER	MARICOPA	7N	3W	21
2	354046	CAT CLAW #1	MARICOPA	7N	3W	13
3	354047	CAT CLAW #2	MARICOPA	7N	3W	13
4	355277	CAT CLAW #3	MARICOPA	7N	3W	24
5	355354	CAT CLAW #4	MARICOPA	7N	3W	13
6	355375	CAT CLAW #5	MARICOPA	7N	3W	24
7	355376	CAT CLAW #6	MARICOPA	7N	3W	24
8	356330	CAT CLAW #7	MARICOPA	7N	3W	24
9	358409	HAVALINA #1	MARICOPA	7N	3W	22
10	358408	HAVALINA #2	MARICOPA	7N	3W	22

List additional claims on Form MCF114.

No. of Claims: 13 x \$125 = 1,625  
 Check No: CD #3467 Init. TMC  
 #1001 & CC 1141627  
 Receipt No.: \_\_\_\_\_  
 For BLM Use Only

Bureau of Land Management  
 Arizona State Office  
[www.az.blm.gov](http://www.az.blm.gov)

Form: MCF112  
 Revised July 2005

This form is available from the Arizona Department of Mines and Mineral Resources and may be reproduced.

RE 9/14/05



LEAD FILE NUMBERS Amc 266964; 268020; 277387; 351675;  
 353269; 353844; 354046; 355276; 355354; 355375;  
 356328; 358408; 362141

AMC NUMBER (S)	AMOUNT	LEAD FILE NUMBER
266964 - 266966	375	Amc 266964
268020 - 268022	375	268020
277387 - 277388	250	277387
351675 - 351677	375	351675
353269	125	353269
353844	125	353844
354046 - 354049	500	354046
355276 - 355277	250	355276
355354	125	355354
355375 - 355376	250	355375
356328 - 356330	375	356328
358408 - 358409	250	358408
362141	125	362141
		Verified 8/30/04 PR
<b>GRAND TOTAL:</b>	\$ 3500 <sup>00</sup>	

# MAINTENANCE FEE PAYMENT

BUREAU OF LAND MANAGEMENT  
 222 N CENTRAL AVENUE  
 PHOENIX, AZ 85004  
 602-417-9200  
 www.az.blm.gov

RECEIVED  
 B.L.M. AZ STATE OFFICE  
 2004 AUG 18 P 2: 39  
 PHOENIX, ARIZONA  
 BLM Date Stamp

Mining Claim Maintenance Fee Payment of \$125 per claim/site is due on or before September 1, 2004, in lieu of assessment work for the upcoming assessment year beginning September 1 of the year noted above.

AMC NUMBER	CLAIM/SITE NAME	COUNTY RECORDER DATA	SEC	TWP	RNG
266964	DONKEY #1	YAV.	35	8N	3W
266965	DONKEY #2	YAV.	35	8N	3W
266966	DONKEY #3	YAV.	35	8N	3W
268020	DONKEY #4	YAV.	35	8N	3W
268021	DONKEY #5	YAV.	35	8N	3W
268022	DONKEY #6	YAV.	35	8N	3W
277387	DONKEY #7	YAV.	35	8N	3W
277388	DONKEY #8	YAV.	35	8N	3W
354048	DONKEY #9	YAV.	35	8N	3W
354049	DONKEY #10	YAV.	35	8N	3W

List additional claims on the reverse side of this form.

Check here if this is a change of address.

CLAIMANT NAME: Beverly Brown  
 ADDRESS: 10502 Cherry Tree LN  
 CITY: Sun City STATE: AZ ZIP: 85373  
 PHONE: 623-972-0057  
 SIGNATURE: Beverly Brown

Claimant or agent must sign to record with the County.

No of Claims: 17 \* \$125 = 2,125.00  
 Check No: CC & Cash Init: TMC  
 Receipt No: 931767  
 FOR BLM USE ONLY

**ENTERED INTO COMPUTER**  
 FORM APPROVED OMB NO. 1004-0114  
 Expires: December 31, 2006  
 AZ-5858-2 (July 2004)

AMC NUMBER	CLAIM/SITE NAME	COUNTY RECORDER DATA	SEC	TWP	RNG
356328	BUZZARD # 1	YAV.	12	7N	3W
356329	BUZZARD # 2	YAV.	12	7N	3W
362141	BUZZARD # 3	YAV.	12	7N	3W
351675	SELECT # 1	YAV.	10	7N	3W
351676	SELECT # 2	YAV.	10	7N	3W
351677	SELECT # 3	YAV.	10	7N	3W
353269	HOG	YAV.	36	8N	3W
		YAV.			
		YAV.			
		YAV.			

43 CFR 3833.0-5(e) (August 30, 1994) requires that the names and current addresses of all owners shall be identified on all instruments to be recorded or filed.

Name: \_\_\_\_\_ Address: \_\_\_\_\_

City: \_\_\_\_\_ State: \_\_\_\_\_ Zip: \_\_\_\_\_  Change of address

Name: \_\_\_\_\_ Address: \_\_\_\_\_

City: \_\_\_\_\_ State: \_\_\_\_\_ Zip: \_\_\_\_\_  Change of address

Name: \_\_\_\_\_ Address: \_\_\_\_\_

City: \_\_\_\_\_ State: \_\_\_\_\_ Zip: \_\_\_\_\_  Change of address

Name: \_\_\_\_\_ Address: \_\_\_\_\_

City: \_\_\_\_\_ State: \_\_\_\_\_ Zip: \_\_\_\_\_  Change of address

Name: \_\_\_\_\_ Address: \_\_\_\_\_

City: \_\_\_\_\_ State: \_\_\_\_\_ Zip: \_\_\_\_\_  Change of address

**PRIVACY ACT STATEMENT** - This information is being collected pursuant to 30 U.S.C. 28, 43 CFR 3833.2, and ARS 27-208 in compliance with the laws of the USDI, Bureau of Land Management, and the State of Arizona. The purpose of this collection is to facilitate processing of claims or applications. This form is covered by Privacy Act Notice #INTERIOR/LLM-32 and is subject to the routine uses stated in that notice. Privacy Act Notice #INTERIOR/LLM-32 is available at the BLM Arizona State Office. This form may be locally reproduced.

**MAINTENANCE FEE PAYMENT**

BUREAU OF LAND MANAGEMENT  
 222 N CENTRAL AVENUE  
 PHOENIX, AZ 85004  
 602-417-9200  
 www.az.blm.gov

Mining Claim Maintenance Fee Payment of \$125 per claim/site is due on or before September 1, 2004, in lieu of assessment work for the upcoming assessment year beginning September 1 of the year noted above.

RECEIVED  
 B.L.M. AZ STATE OFFICE  
 2004 AUG 18 P 2:39  
 PHOENIX, ARIZONA  
 BLM Date Stamp

AMC NUMBER	CLAIM/SITE NAME	COUNTY RECORDER DATA	SEC	TWP	RNG
353 844	Red Rooster	Maricopa	21	7N	3W
354 046	Catclaw #1	Maricopa	13	7N	3W
354 047	Catclaw #2	Maricopa	13	7N	3W
355 277	Catclaw #3	Maricopa	24	7N	3W
355 354	Catclaw #4	Maricopa	13	7N	3W
355 375	Catclaw #5	Maricopa	24	7N	3W
355 376	Catclaw #6	Maricopa	24	7N	3W
356 330	Catclaw #7	Maricopa	24	7N	3W
358 409	Havalina #1	Maricopa	22	7N	3W
358 408	Havalina #2	Maricopa	22	7N	3W

List additional claims on the reverse side of this form.

Check here if this is a change of address.

CLAIMANT NAME: Beverly Brown  
 ADDRESS: 10502 Cherry Tree Ln  
 CITY: Sun City STATE: AZ ZIP: 85373  
 PHONE: 623-972-0057  
 SIGNATURE: Beverly Brown

No of Claims: 11 x \$125 = 1,375.00  
 Check No: CC & Cash Init: HMC  
 Receipt No: 931767  
**FOR BLM USE ONLY**

Claimant or agent must sign to record with the County.

AMC NUMBER	CLAIM/SITE NAME	COUNTY RECORDER DATA	SEC	TWP	RNG
355276	Brass Ring	Maricopa	21	7N	3W

43 CFR 3833.0-5(e) (August 30, 1994) requires that the names and current addresses of all owners shall be identified on all instruments to be recorded or filed.

Name: \_\_\_\_\_ Address: \_\_\_\_\_

City: \_\_\_\_\_ State: \_\_\_\_\_ Zip: \_\_\_\_\_  Change of address

Name: \_\_\_\_\_ Address: \_\_\_\_\_

City: \_\_\_\_\_ State: \_\_\_\_\_ Zip: \_\_\_\_\_  Change of address

Name: \_\_\_\_\_ Address: \_\_\_\_\_

City: \_\_\_\_\_ State: \_\_\_\_\_ Zip: \_\_\_\_\_  Change of address

Name: \_\_\_\_\_ Address: \_\_\_\_\_

City: \_\_\_\_\_ State: \_\_\_\_\_ Zip: \_\_\_\_\_  Change of address

Name: \_\_\_\_\_ Address: \_\_\_\_\_

City: \_\_\_\_\_ State: \_\_\_\_\_ Zip: \_\_\_\_\_  Change of address

**PRIVACY ACT STATEMENT** – This information is being collected pursuant to 30 U.S.C. 28, 43 CFR 3833.2, and ARS 27-208 in compliance with the laws of the USDI, Bureau of Land Management, and the State of Arizona. The purpose of this collection is to facilitate processing of claims or applications. This form is covered by Privacy Act Notice #INTERIOR/LLM -32 and is subject to the routine uses stated in that notice. Privacy Act Notice #INTERIOR/LLM-32 is available at the BLM Arizona State Office. This form may be locally reproduced.

**United States Department of the Interior**  
**Bureau of Land Management**  
 BUSINESS & SUPPORT SVCS DIV  
 222 N CENTRAL AVE  
 PHOENIX, AZ 85004 -2203  
 Phone: (602) 417-9200

Receipt	
No:	931767

<b>Transaction #:</b> 966034
<b>Date of Transaction:</b> 08/18/2004
<b>CUSTOMER:</b> BEVERLY BROWN DAVID KINZENBAW 10502 CHERRY TREE LN SUN CITY, AZ 85373

LINE #	QTY	DESCRIPTION	REMARKS	UNIT PRICE	TOTAL
1	1.00	LOCATABLE MINERALS / MINING CLAIMS-NOT NEW-UNADJUD, ONE AUTH NO. ONLY / MINING CLAIM MONEY RECEIVED (455) CASES: AMC266964/\$3500.00	MAINT 2005/28	- n/a -	3500.00
<b>TOTAL:</b>					<b>\$3,500.00</b>

PAYMENT INFORMATION																													
NOTE: Items will appear on credit card statement as "Bureau of Land Management".																													
1	<table border="1" style="width: 100%;"> <tr> <td style="width: 15%;">AMOUNT:</td> <td>\$1,750.00</td> <td style="width: 15%;">POSTMARKED:</td> <td>N/A</td> </tr> <tr> <td>TYPE:</td> <td>CASH</td> <td>RECEIVED:</td> <td>08/18/2004</td> </tr> <tr> <td>NAME:</td> <td colspan="3">DAVID KINZENBAW BROWN, BEVERLY 10502 CHERRY TREE LN SUN CITY AZ 85373</td> </tr> </table>	AMOUNT:	\$1,750.00	POSTMARKED:	N/A	TYPE:	CASH	RECEIVED:	08/18/2004	NAME:	DAVID KINZENBAW BROWN, BEVERLY 10502 CHERRY TREE LN SUN CITY AZ 85373																		
AMOUNT:	\$1,750.00	POSTMARKED:	N/A																										
TYPE:	CASH	RECEIVED:	08/18/2004																										
NAME:	DAVID KINZENBAW BROWN, BEVERLY 10502 CHERRY TREE LN SUN CITY AZ 85373																												
2	<table border="1" style="width: 100%;"> <tr> <td style="width: 15%;">AMOUNT:</td> <td>\$1,750.00</td> <td style="width: 15%;">POSTMARKED:</td> <td>N/A</td> </tr> <tr> <td>TYPE:</td> <td>CREDIT CARD</td> <td>RECEIVED:</td> <td>08/18/2004</td> </tr> <tr> <td>NAME:</td> <td colspan="3">DAVID KINZENBAW BROWN, BEVERLY 10502 CHERRY TREE LN SUN CITY AZ 85373</td> </tr> <tr> <td>CARD NO:</td> <td>XXXXXXXXXXXX2786</td> <td>AUTH CODE:</td> <td>092097</td> </tr> <tr> <td>NAME ON CARD:</td> <td colspan="3">BROWN/BEVERLY M</td> </tr> <tr> <td>EXPIRES:</td> <td colspan="3">04/30/2005</td> </tr> <tr> <td>SIGNATURE:</td> <td colspan="3"></td> </tr> </table>	AMOUNT:	\$1,750.00	POSTMARKED:	N/A	TYPE:	CREDIT CARD	RECEIVED:	08/18/2004	NAME:	DAVID KINZENBAW BROWN, BEVERLY 10502 CHERRY TREE LN SUN CITY AZ 85373			CARD NO:	XXXXXXXXXXXX2786	AUTH CODE:	092097	NAME ON CARD:	BROWN/BEVERLY M			EXPIRES:	04/30/2005			SIGNATURE:			
AMOUNT:	\$1,750.00	POSTMARKED:	N/A																										
TYPE:	CREDIT CARD	RECEIVED:	08/18/2004																										
NAME:	DAVID KINZENBAW BROWN, BEVERLY 10502 CHERRY TREE LN SUN CITY AZ 85373																												
CARD NO:	XXXXXXXXXXXX2786	AUTH CODE:	092097																										
NAME ON CARD:	BROWN/BEVERLY M																												
EXPIRES:	04/30/2005																												
SIGNATURE:																													



AMC 355375  
356328  
351675  
266964  
268020

AMC 277387  
353844  
353269

AMC ~~351677~~  
354046  
355276  
355354

**MAINTENANCE FEE PAYMENT**

Mining Claim Maintenance Fee Payment of \$100 per claim or site is due on or before September 1, 20<sup>03</sup>, in lieu of assessment work for the upcoming assessment year beginning September 1 of the year noted above.

BUREAU OF LAND MANAGEMENT  
ARIZONA STATE OFFICE  
222 NORTH CENTRAL AVENUE  
PHOENIX, AZ 85004  
602-417-9200  
www.az.blm.gov

**FOR BLM USE ONLY**  
NO. OF CLAIMS: 25 X \$100 = \$ 2500<sup>00</sup>  
RECEIPT NO.: \_\_\_\_\_ CHECK NO.: \_\_\_\_\_  
INIT: cd

BLM SERIAL NUMBERS	NAME OF CLAIMS/SITES	COUNTY BOOK/DOCKET & PAGE OR FEE NUMBER
1. AMC <u>354 046</u>	_____	_____
2. AMC <u>354 047</u>	_____	_____
3. AMC <u>355 277</u>	_____	_____
4. AMC <u>355 354</u>	_____	_____
5. AMC <u>355 375</u>	_____	_____
6. AMC <u>355 376</u>	_____	_____
7. AMC <u>356 330</u>	_____	_____
8. AMC <u>351 675</u>	_____	_____
9. AMC <u>351 676</u>	_____	_____
10. AMC <u>351 677</u>	_____	_____

List additional claims on the reverse side of this form.

CHECK HERE IF THIS IS A CHANGE OF ADDRESS

CLAIMANT'S NAME: David R. Kinzenbaw  
ADDRESS: 4144 W Dahlia  
CITY: Phoenix STATE: AZ ZIP: 85029  
PHONE: 623-680 2999

Signature: \_\_\_\_\_  
To record with the County, one claimant or an agent must sign.

10502 Cherry Tree Ln  
Sun City, AZ 85373

PHOENIX, ARIZONA  
2003 AUG - 1 P 3:57  
RECEIVED OFFICE  
BLM, AZ STATE OFFICE  
BLM DATE STAMP

ENTERED IN COMPUTER  
8/14/2003 TXL

NAME: \_\_\_\_\_ ADDRESS: \_\_\_\_\_  
CITY: \_\_\_\_\_ STATE: \_\_\_\_\_ ZIP: \_\_\_\_\_ IS THIS A NEW ADDRESS

NAME: \_\_\_\_\_ ADDRESS: \_\_\_\_\_  
CITY: \_\_\_\_\_ STATE: \_\_\_\_\_ ZIP: \_\_\_\_\_ IS THIS A NEW ADDRESS

NAME: \_\_\_\_\_ ADDRESS: \_\_\_\_\_  
CITY: \_\_\_\_\_ STATE: \_\_\_\_\_ ZIP: \_\_\_\_\_ IS THIS A NEW ADDRESS

NAME: \_\_\_\_\_ ADDRESS: \_\_\_\_\_  
CITY: \_\_\_\_\_ STATE: \_\_\_\_\_ ZIP: \_\_\_\_\_ IS THIS A NEW ADDRESS

NAME: \_\_\_\_\_ ADDRESS: \_\_\_\_\_  
CITY: \_\_\_\_\_ STATE: \_\_\_\_\_ ZIP: \_\_\_\_\_ IS THIS A NEW ADDRESS

NAME: \_\_\_\_\_ ADDRESS: \_\_\_\_\_  
CITY: \_\_\_\_\_ STATE: \_\_\_\_\_ ZIP: \_\_\_\_\_ IS THIS A NEW ADDRESS

NAME: \_\_\_\_\_ ADDRESS: \_\_\_\_\_  
CITY: \_\_\_\_\_ STATE: \_\_\_\_\_ ZIP: \_\_\_\_\_ IS THIS A NEW ADDRESS

NAME: \_\_\_\_\_ ADDRESS: \_\_\_\_\_  
CITY: \_\_\_\_\_ STATE: \_\_\_\_\_ ZIP: \_\_\_\_\_ IS THIS A NEW ADDRESS

FOR BLM USE ONLY	
DATE ENTERED INTO COMPUTER:	_____
INITIALS:	_____ VERIFIED: _____

BLM SERIAL NUMBERS	NAME OF CLAIMS/SITES	COUNTY BOOK/DOCKET & PAGE OR FEE NUMBER
11. A MC 266 964	DONKEY	
12. A MC 266 965	DONKEY	
13. A MC 266 966	DONKEY	
14. A MC 268 020	DONKEY	
15. A MC 268-021	DONKEY	
16. A MC 268 022	DONKEY	
17. A MC 277 387	DONKEY	
18. A MC 277 388	DONKEY	
19. A MC 354 048	DONKEY	
20. A MC 354 049	DONKEY	
21. A MC 356 328	BUZZARD	
22. A MC 356 329	BUZZARD	
23. A MC 353 844	RED ROOSTER	
24. A MC 353 269	HOG	
25. A MC 355 276	BRASS RING	
A MC		
A MC		
A MC		
A MC		
A MC		
A MC		
A MC		
A MC		
A MC		
A MC		
A MC		
A MC		
A MC		
A MC		
A MC		

RECEIVED  
 BLM. AZ STATE OFFICE  
 2003 AUG 1 P 3:58  
 PHOENIX ARIZONA  
 TIME STAMP

**FOR OFFICIAL USE ONLY**  
 ENTERED INTO COMPUTER: 8/14/03 ML ADL  
 DATE INITIALS VERIFIED

**United States Department of the Interior  
Bureau of Land Management**

BUSINESS & SUPPORT SVCS DIV  
222 N CENTRAL AVE  
PHOENIX, AZ 85004 -2203  
Phone: (602) 417-9200

Receipt	
No:	722350

**Transaction #:** 751563  
**Date of Transaction:** 08/01/2003

**CUSTOMER:** DAVID R KINZENBAW  
4001 W DAHLIA  
PHOENIX,AZ 85029

LINE #	QTY	DESCRIPTION	REMARKS	UNIT PRICE	TOTAL
1	1.00	LOCATABLE MINERALS / MINING CLAIMS-NOT NEW-UNADJUD,ONE AUTH NO. ONLY / MINING CLAIM MONEY RECEIVED (455) <b>CASES:</b> AMC354046/\$2500.00	MAINT 2004 (25)	- n/a -	2500.00
<b>TOTAL:</b>					<b>\$2,500.00</b>

**PAYMENT INFORMATION**

NOTE: Items will appear on credit card statement as "Bureau of Land Management".

1	AMOUNT:	\$1,300.00	POSTMARKED:	N/A
	TYPE:	CREDIT CARD	RECEIVED:	08/01/2003
	NAME:	BROWN, BEVERLY 10502 CHERRY TREE LN SUN CITY AZ 85373		
	CARD NO:	XXXXXXXXXXXX2786	AUTH CODE:	001602
	NAME ON CARD:	BROWN/BEVERLY M		
	EXPIRES:	04/30/2005		
	SIGNATURE:			
2	AMOUNT:	\$1,200.00	POSTMARKED:	N/A
	TYPE:	CHECK	RECEIVED:	08/01/2003
	CHECK NO:	2218		
	NAME:	KINZENBAW, DAVID 4144 W DAHLIA PHOENIX AZ 85029		

**REMARKS**

This receipt was generated by the automated BLM Collections and Billing System and is a paper representation of a portion of the official electronic record contained therein.



**MAINTENANCE FEE PAYMENT**

Mining Claim Maintenance Fee Payment of \$100 per claim or site is due on or before September 1, 2002, in lieu of assessment work for the upcoming assessment year beginning September 1 of the year noted above.

BUREAU OF LAND MANAGEMENT  
ARIZONA STATE OFFICE  
222 NORTH CENTRAL AVENUE  
PHOENIX, AZ 85004  
602-417-9200  
www.az.blm.gov

<b>FOR BLM USE ONLY</b>		
NO. OF CLAIMS: <u>11</u>	X \$100 = \$	<u>1,100.<sup>00</sup></u>
RECEIPT NO.:	CHECK NO.:	
INIT:		

The claims are situated in MARICOPA County, Arizona.

**BLM SERIAL NUMBERS**

**NAMES OF CLAIMS OR SITES**

AMC \_\_\_\_\_ THRU AMC \_\_\_\_\_ NAME: \_\_\_\_\_  
 COUNTY BOOK/DOCKET \_\_\_\_\_, PAGE OR FEE NO: \_\_\_\_\_  
 AMC \_\_\_\_\_ THRU AMC \_\_\_\_\_ NAME: \_\_\_\_\_  
 COUNTY BOOK/DOCKET \_\_\_\_\_, PAGE OR FEE NO: \_\_\_\_\_

**IF NOT CONSECUTIVE NUMBERS LIST SEPARATELY BELOW**

BLM SERIAL NUMBERS	NAME OF CLAIMS/SITES	CO/BOOK DOCKET & PAGE OR FEE NUMBER
AMC <u>354046</u>	<u>CAT CLAW #1</u>	_____
AMC <u>354047</u>	<u>CAT CLAW #2</u>	_____
AMC <u>355277</u>	<u>CAT CLAW #3</u>	_____
AMC <u>355354</u>	<u>CAT CLAW #4</u>	_____

List additional claims on the reverse side of this form.

CLAIMANT'S NAME: Kelly R Brown  
 ADDRESS: 16502 K Hwy Tucson CITY: SUNNY STATE: AZ ZIP: 85373  
 PHONE: 623 0057

Check here if this is a change of address

**ENTERED INTO COMPUTER**

11/14/02 AB

PHOENIX, ARIZONA
2002 JUL 23 P 2:27
RECEIVED B.L.M. AZ STATE OFFICE
BLM DATE STAMP

BLM SERIAL  
NUMBERS

NAME OF CLAIMS/SITES

CO/BOOK DOCKET &  
PAGE OR FEE NUMBER

AMC <u>355375</u>	<u>CAT CLAW #5</u>	
AMC <u>355376</u>	<u>CAT CLAW #6</u>	
AMC <u>356330</u>	<u>CAT CLAW #7</u>	
AMC <u>355276</u>	<u>BRASS RING #1</u>	
AMC <u>356177</u>	<u>BRASS RING #2</u>	
AMC <u>353844</u>	<u>RED ROOSTER</u>	
AMC <u>350492</u>	<u>BEANER</u>	
AMC _____	_____	_____
AMC _____	_____	_____
AMC _____	_____	_____
AMC _____	_____	_____
AMC _____	_____	_____
AMC _____	_____	_____
AMC _____	_____	_____
AMC _____	_____	_____
AMC _____	_____	_____

43 CFR 3833.0-5(e) (August 30, 1994) requires that the names of all of the owners and their current addresses shall be identified on all instruments required to be recorded or filed by the regulation, 43 CFR Subpart 3833.

NAME: DAVID R KENZENBAW ADDRESS: 4144 W. DALLA  
CITY: PHX STATE: AZ ZIP: 85029 IS THIS A NEW ADDRESS

NAME: David R. Kenzie ADDRESS: \_\_\_\_\_  
CITY: \_\_\_\_\_ STATE: \_\_\_\_\_ ZIP: \_\_\_\_\_ IS THIS A NEW ADDRESS

NAME: \_\_\_\_\_ ADDRESS: \_\_\_\_\_  
CITY: \_\_\_\_\_ STATE: \_\_\_\_\_ ZIP: \_\_\_\_\_ IS THIS A NEW ADDRESS

NAME: \_\_\_\_\_ ADDRESS: \_\_\_\_\_  
CITY: \_\_\_\_\_ STATE: \_\_\_\_\_ ZIP: \_\_\_\_\_ IS THIS A NEW ADDRESS

Signature Kelly R Brown  
To record with the County, one claimant or an agent must sign.

March 11, 2002

FOR BLM USE ONLY	
DATE ENTERED INTO COMPUTER: _____	INITIALS: _____
VERIFIED: _____	

**MAINTENANCE FEE PAYMENT**

Mining Claim Maintenance Fee Payment of \$100 per claim or site is due on or before September 1, 2002, in lieu of assessment work for the upcoming assessment year beginning September 1 of the year noted above.

BUREAU OF LAND MANAGEMENT  
ARIZONA STATE OFFICE  
222 NORTH CENTRAL AVENUE  
PHOENIX, AZ 85004  
602-417-9200  
www.az.blm.gov

<b>FOR BLM USE ONLY</b>	
NO. OF CLAIMS: <u>16</u>	X \$100 = \$ <u>1,600.<sup>00</sup></u>
RECEIPT NO.: <u>527236</u>	CHECK NO.: <u>CC</u>
INIT: <u>MC</u>	

The claims are situated in YAVAPAI County, Arizona.

**BLM SERIAL NUMBERS**

**NAMES OF CLAIMS OR SITES**

AMC \_\_\_\_\_ THRU AMC \_\_\_\_\_ NAME: \_\_\_\_\_  
 COUNTY BOOK/DOCKET \_\_\_\_\_, PAGE OR FEE NO: \_\_\_\_\_  
 AMC \_\_\_\_\_ THRU AMC \_\_\_\_\_ NAME: \_\_\_\_\_  
 COUNTY BOOK/DOCKET \_\_\_\_\_, PAGE OR FEE NO: \_\_\_\_\_

**IF NOT CONSECUTIVE NUMBERS LIST SEPARATELY BELOW**

BLM SERIAL NUMBERS	NAME OF CLAIMS/SITES	CO/BOOK DOCKET & PAGE OR FEE NUMBER
AMC <u>353269</u>	<u>HOG</u>	_____
AMC <u>351675</u>	<u>SELECT #1</u>	_____
AMC <u>351676</u>	<u>SELECT #2</u>	_____
AMC <u>351677</u>	<u>SELECT #3</u>	_____

List additional claims on the reverse side of this form.

CLAIMANT'S NAME: Riley R Brown  
 ADDRESS: 16562 CHERRY TRAIL LN CITY: SWICED STATE: AZ ZIP: 85373  
 PHONE: 623 9720657

Check here if this is a change of address

ENTERED IN COMPUTER  
8/15/02 MAH

PHOENIX, ARIZONA  
 2002 JUL 23 P 2: 27  
 RECEIVED  
 B.L.M. AZ STATE OFFICE  
 BLM DATE STAMP



BLM SERIAL  
NUMBERS

NAME OF CLAIMS/SITES

CO/BOOK DOCKET &  
PAGE OR FEE NUMBER

AMC 356328

BUZZARD #1

AMC 356329

BUZZARD #2

AMC 266964

DONKEY #1

AMC 266965

DONKEY #2

AMC 266966

DONKEY #3

AMC 268020

DONKEY #4

AMC 268021

DONKEY #5

AMC 268022

DONKEY #6

AMC 277387

DONKEY #7

AMC 277388

DONKEY #8

AMC 354048

DONKEY #9

AMC 554649

DONKEY #10

AMC 354049

AMC \_\_\_\_\_

AMC \_\_\_\_\_

43 CFR 3833.0-5(e) (August 30, 1994) requires that the names of all of the owners and their current addresses shall be identified on all instruments required to be recorded or filed by the regulation, 43 CFR Subpart 3833.

NAME: DAVID R KINZEBAW ADDRESS: 4144 W. DAHLIA DR

CITY: PHX STATE: AZ ZIP: 85029 IS THIS A NEW ADDRESS

David R. Kinze

NAME: \_\_\_\_\_ ADDRESS: \_\_\_\_\_

CITY: \_\_\_\_\_ STATE: \_\_\_\_\_ ZIP: \_\_\_\_\_ IS THIS A NEW ADDRESS

NAME: \_\_\_\_\_ ADDRESS: \_\_\_\_\_

CITY: \_\_\_\_\_ STATE: \_\_\_\_\_ ZIP: \_\_\_\_\_ IS THIS A NEW ADDRESS

NAME: \_\_\_\_\_ ADDRESS: \_\_\_\_\_

CITY: \_\_\_\_\_ STATE: \_\_\_\_\_ ZIP: \_\_\_\_\_ IS THIS A NEW ADDRESS

Signature: Kelly R Beaur

To record with the County, one claimant or an agent must sign.

FOR BLM USE ONLY	
DATE ENTERED INTO COMPUTER: _____	INITIALS: _____
VERIFIED: _____	

**United States Department of the Interior**  
**Bureau of Land Management**  
 BUSINESS & SUPPORT SVCS DIV  
 222 N CENTRAL AVE  
 PHOENIX, AZ 85004 -2203  
 Phone: (602) 417-9200

Receipt	
No:	527236

<b>Transaction #:</b> 551381
<b>Date of Transaction:</b> 07/23/2002
<b>CUSTOMER:</b> KELLY R BROWN 10502 CHERRY TREE LN SUN CITY, AZ 85373

LINE #	QTY	DESCRIPTION	REMARKS	UNIT PRICE	TOTAL
1	1.00	LOCATABLE MINERALS / MINING CLAIMS-NOT NEW-UNADJUD, ONE AUTH NO. ONLY / MINING CLAIM MONEY RECEIVED (455) <b>CASES:</b> AMC353269/\$2700.00	MAINT 2003 (27)	- n/a -	2700.00
<b>TOTAL:</b>					<b>\$2,700.00</b>

PAYMENT INFORMATION		
NOTE: Items will appear on credit card statement as "Bureau of Land Management".		
1	AMOUNT: \$2,025.00	POSTMARKED: N/A
	TYPE: CREDIT CARD	RECEIVED: 07/23/2002
	NAME: BROWN, KELLY R 10502 CHERRY TREE LN SUN CITY AZ 85373	
	CARD NO: XXXXXXXXXXXX2786	AUTH CODE: 023003
	NAME ON CARD: BROWN/KELLY R	
	EXPIRES: 04/30/2005	
	SIGNATURE:	
2	AMOUNT: \$675.00	POSTMARKED: N/A
	TYPE: CREDIT CARD	RECEIVED: 07/23/2002
	NAME: BROWN, KELLY R 10502 CHERRY TREE LN SUN CITY AZ 85373	
	CARD NO: XXXXXXXXXXXX6616	AUTH CODE: 677669
	NAME ON CARD: KINZENBAW/ DAVID	
	EXPIRES: 09/30/2003	
	SIGNATURE:	

REMARKS

This receipt was generated by the automated BLM Collections and Billing System and is a paper representation of a portion of the official electronic record contained therein.

**NOTICE!!**

**These documents have been scanned!**

**Do not place un-scanned documents beneath this notice!**

**Do not remove this notice from this file!**

GPO Jacket No. 560-102  
Print Order 61540  
Rise Business Services, LLC  
Job=AZ15 7/1/2019



Box Number= AZ15136



Claim Begin-End: AMC355354-AMC355354

**5 Miscellaneous**



AZ15136-10

AMC355012-AMC355391

**NO  
DOCUMENTS  
FOUND**

NO DOCUMENTS FOUND  
NO DOCUMENTS FOUND

**NOTICE!!**

**These documents have been scanned!**

**Do not place un-scanned documents beneath this notice!**

**Do not remove this notice from this file!**

GPO Jacket No. 560-102  
Print Order 61540  
Rise Business Services, LLC  
Job=AZ15 7/1/2019



Box Number= AZ15136



Claim Begin-End: AMC355354-AMC355354

**6 Location Notices-Amendments and Supporting Documents**



AZ15136-10 AMC355012-AMC355391

AZ-1274-4  
(June 1987)

DEPARTMENT OF THE INTERIOR  
BUREAU OF LAND MANAGEMENT  
ARIZONA STATE OFFICE

EXAMINATION OF CASE FILE

A SEPARATE FORM MUST BE COMPLETED FOR EACH LEAD SERIAL NUMBER:

SERIAL NUMBER	TYPE OF CASE
355354	MINING CLAIM

I David R. Kenzler HAVE READ AND UNDERSTOOD THE WARNINGS RELATIVE TO TITLE 18 U.S.C. 1001 AND 2071 PRINTED ON THIS FORM AND REQUEST TO EXAMINE THE CASE RECORD BEARING THE ABOVE SERIAL NUMBER OR NAME. I AGREE NOT TO REMOVE OR ALTER THE CONTENTS OF THIS FILE IN ANY MANNER WHATSOEVER AND NOT TO REMOVE THE FILE FROM THE ROOM DESIGNATED FOR PUBLIC EXAMINATION OF SUCH RECORDS.

NAME: <u>DAVID R KENZLER</u>	DATE: <u>1/5/02</u>
ADDRESS: <u>4144 W. DAHLIA</u>	

(PLEASE PRINT INCLUDING ZIP CODE)

\*\*\*\*\*

- WARNING -

Title 18 U.S. Code 1001. Statements or entries generally

Whoever, in any manner within the jurisdiction of any department or agency of the United States knowingly and willfully falsifies, conceals or covers up by any trick, scheme, or a device a material fact, or makes any false, fictitious or fraudulent statements or representations, or makes or uses any false writing or document knowing the same to contain any false, fictitious or fraudulent statement or entry, shall be fined not more than \$10,000 or imprisoned not more than five years, or both.

- Warning -

Title 18 U.S. Code 2071. Concealment, removal or mutilation generally

Whoever, willfully and unlawfully conceals, removes, mutilates, obliterates, or destroys, or attempts to do so, or, with intent to do so takes and carries away any record, proceeding, map book, paper, document, or other thing, filed or deposited with any clerk or officer of any court of the United States, or in any public office, or with any judicial or public officer of the United States, shall be fined not more than \$2,000 or imprisoned not more than three years.

**DEPARTMENT OF THE INTERIOR  
BUREAU OF LAND MANAGEMENT  
MINING CLAIMS**

**(LIVE) Serial Register Page**

RunDate/Time: 04/02/01 10:45 AM

Page 1 of 1

**01 05-10-1872;017STAT0091;30USC26,28,34**  
**Case Type 384101: LODE CLAIM**  
**Claim Name: CAT CLAW #4**  
**Commodity :**  
**Case Disposition: ACTIVE**

**Serial Number  
AMC355354**

Name & Address			Int Rel	% Interest
BROWN KELLY R	10502 CHERRY TREE LN	SUN CITY, AZ 85373	CLAIMANT	0.000000
KINZENBAW DAVID R	4001 W DAHLIA	PHOENIX, AZ 85029	CLAIMANT	0.000000

Mer Twp	Rng	Sec	Quadrant	District/Resource	County	
14	0070N	0030W	013	SE	PHOENIX FIELD OFFICE	YAVAPAI
14	0070N	0030W	013	SE	PHOENIX FIELD OFFICE	MARICOPA
14	0070N	0030W	024	NE	PHOENIX FIELD OFFICE	MARICOPA

*Done 4/14/01*

Act Date	Code	Action	Action Remarks	Receipt Number
02/28/2001	403	LOCATION DATE		
03/29/2001	395	RECORDATION NOTICE RECD		
03/29/2001	484	LOCATION YEAR/MAINTENANCE FEE	2001	282000
03/30/2001	669	LAND STATUS CHECKED		
03/29/2001	501	ACCT ADV IN LEAD FILE	AMC355354;	

Line Nr Remarks

**MINING CLAIM STATUS REPORT**

Status Checked By:	KC
MTP Checked By:	KC
GEO Checked By:	KC 4/2/01
Preadjudication By:	
Final Adjudication By:	

*Status Cash Scan*

LEAD SERIAL NO. AMC 355354 THROUGH AMC \_\_\_\_\_

_____ 1	LODE	@ \$25 = \$ _____	Location Fee
_____	PLACER	@ \$10 = \$ _____	Service Fee--curable defect
_____	MILL SITE	@ \$100 = \$ _____	Claim Maintenance Fee
_____	TUNNEL SITE	\$ _____	<b>TOTAL FEES</b>
_____	ASSOCIATION	\$ _____	Copy Fees
_____	PLACER	\$ _____	Overage <input type="checkbox"/> Shortage <input type="checkbox"/>
		\$ <u>135.26</u>	<b>TOTAL RECEIVED</b>

*DM 5/29/01*

OVER-THE-COUNTER:  MAIL:  Timely Filed: YES  NO

**LEGAL DESCRIPTION:**

T <u>7N</u>	R <u>3W</u>	S <u>24, 13</u>	T _____	R _____	S _____
T _____	R _____	S _____	T _____	R _____	S _____
T _____	R _____	S _____	T _____	R _____	S _____
T _____	R _____	S _____	T _____	R _____	S _____

GENERAL JURISDICTION: BLM  or NATIONAL FOREST  \_\_\_\_\_

Name

SPLIT ESTATE LAND: SX  PX  SRHE  OTHER  N/A

Specify

WILDERNESS AREA (WA): N/A

Specify

CLAIMS SUBJECT TO PL 359: YES  NO

PROPER NOTICE FILED IF LOCATING ON SRHE: YES  NO

COMMENTS: \_\_\_\_\_  
\_\_\_\_\_  
\_\_\_\_\_  
\_\_\_\_\_

STATUS: PARTIALLY VOID  VOID

PRIVATE MINERALS  WITHDRAWN  OTHER

COMMENTS: \_\_\_\_\_  
\_\_\_\_\_  
\_\_\_\_\_  
\_\_\_\_\_  
\_\_\_\_\_  
\_\_\_\_\_  
\_\_\_\_\_  
\_\_\_\_\_  
\_\_\_\_\_





# MAP

One inch = One thousand feet

North Arrow

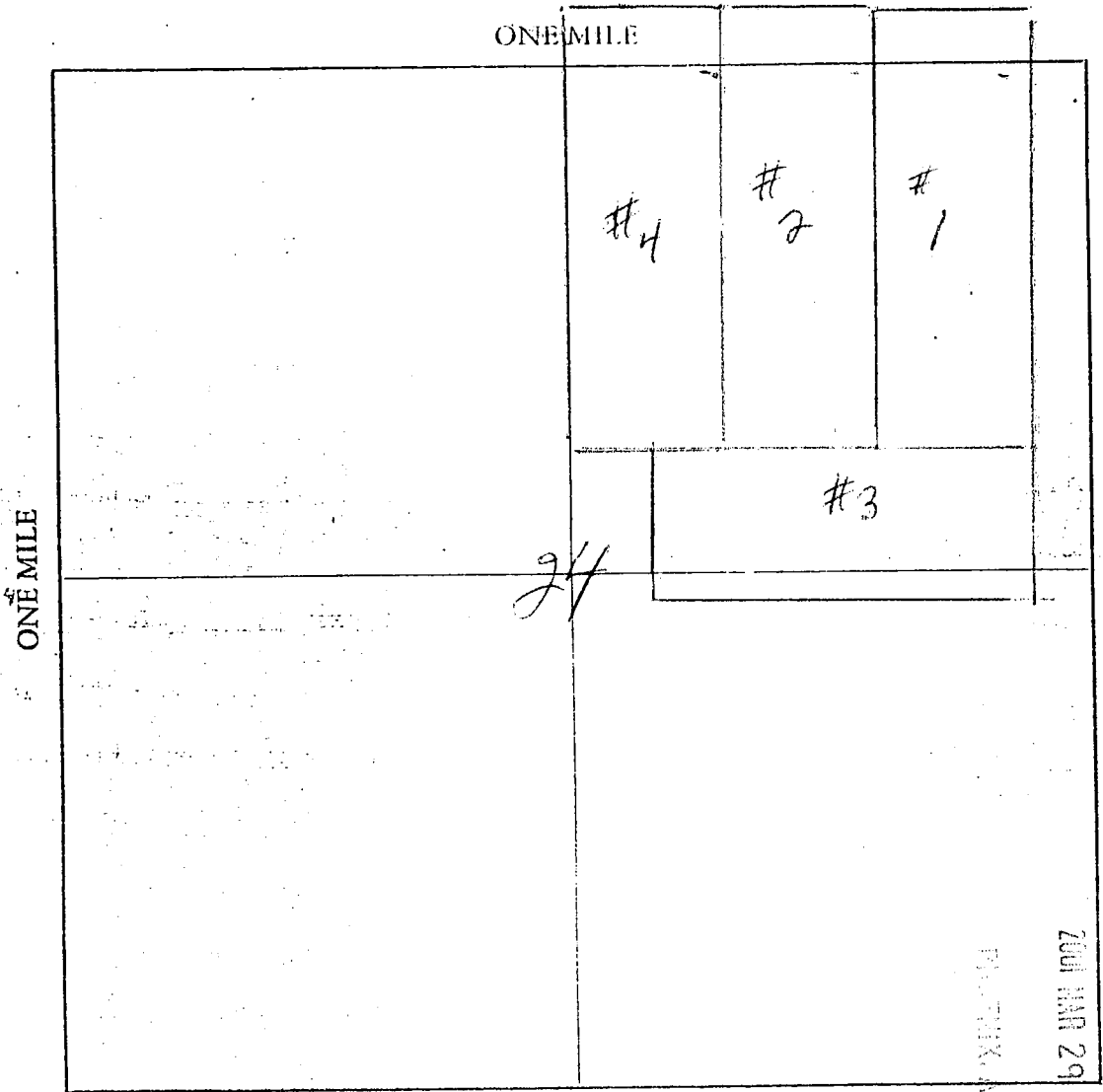

Section 24 Range 3W Township 7N

Date FEB 28/2001

David A. K...  
Signature

PLAZA ARIZONA

2001 MAR 29 P 2:31

640 ACRES

RECEIVED  
LAND SURVEY OFFICE  
G&SRB&M

ANL 355354

**Input Parameters for Geographic Report with Land**

**System Id = CR**

**Admin State = AZ**

**Geo State =**

**Casetype begins with**

**Case Disp Txt =**

**Mer Twp Rng =**

**Mtrs = 14 0070N 0030W 013**

**Commodity =**

**Pending Org =**

**Total Rows Returned: 6**

**NO WARRANTY IS MADE BY BLM  
FOR USE OF THE DATA FOR  
PURPOSES NOT INTENDED BY  
BLM**

RUN TIME: 06:42 AM

Adm State: AZ

UNITED STATES DEPARTMENT OF INTERIOR  
BUREAU OF LAND MANAGEMENT  
GEOGRAPHIC REPORT WITH LAND  
Sorted by Meridian Township Range

RUN DATE: 04/02/2001  
Page 1 of 2

Serial Number: AZA 015036  
Total Case Acres: 7,343.026

<u>Casetype</u>	<u>Case Disp</u>	14	0070N	0030W	<u>Sect</u>	<u>Sur Typ</u>	<u>Sur Num</u>	<u>Suff</u>	<u>Subdivision</u>	<u>Act Pend</u>
311111	CLOSED				013	ALIQ LOTS			NENE,NWNW,S2N2,S2; 1,2;	

Serial Number: AZA 025695  
Total Case Acres: 1.000

<u>Casetype</u>	<u>Case Disp</u>	14	0070N	0030W	<u>Sect</u>	<u>Sur Typ</u>	<u>Sur Num</u>	<u>Suff</u>	<u>Subdivision</u>	<u>Act Pend</u>
380913	AUTHORIZED				013	FF		1	PART;	

Serial Number: AZA 025724  
Total Case Acres: 1.000

<u>Casetype</u>	<u>Case Disp</u>	14	0070N	0030W	<u>Sect</u>	<u>Sur Typ</u>	<u>Sur Num</u>	<u>Suff</u>	<u>Subdivision</u>	<u>Act Pend</u>
380913	AUTHORIZED				013	FF		1	PART;	

Serial Number: AZA 025974  
Total Case Acres: 1.000

<u>Casetype</u>	<u>Case Disp</u>	14	0070N	0030W	<u>Sect</u>	<u>Sur Typ</u>	<u>Sur Num</u>	<u>Suff</u>	<u>Subdivision</u>	<u>Act Pend</u>
380913	AUTHORIZED				013	FF		1	PART;	

Serial Number: AZA 028092  
Total Case Acres: 1.000

<u>Casetype</u>	<u>Case Disp</u>	14	0070N	0030W	<u>Sect</u>	<u>Sur Typ</u>	<u>Sur Num</u>	<u>Suff</u>	<u>Subdivision</u>	<u>Act Pend</u>
380913	AUTHORIZED				013	FF		1	PORTION OF N2;	

**RUN TIME: 06:42 AM**

**Adm State: AZ**

**UNITED STATES DEPARTMENT OF INTERIOR  
BUREAU OF LAND MANAGEMENT  
GEOGRAPHIC REPORT WITH LAND  
Sorted by Meridian Township Range**

**RUN DATE: 04/02/2001**

**Page 2 of 2**

**Input Parameters for Geographic Report with Land**

**System Id = CR**

**Admin State = AZ**

**Geo State =**

**Casetype begins with**

**Case Disp Txt = AUTHORIZED, CANCELLED, CLOSED, EXPIRED, No M**

**Mer Twp Rng =**

**Mtrs = 14 0070N 0030W 024**

**Commodity =**

**Pending Org =**

**Total Rows Returned: 13**

**NO WARRANTY IS MADE BY BLM  
FOR USE OF THE DATA FOR  
PURPOSES NOT INTENDED BY  
BLM**

RUN TIME: 02:07 PM

UNITED STATES DEPARTMENT OF INTERIOR  
BUREAU OF LAND MANAGEMENT  
GEOGRAPHIC REPORT WITH LAND  
Sorted by Serial Number

RUN DATE: 03/29/2001  
Page 1 of 3

Adm State: AZ

Serial Number: AZA 011317  
Total Case Acres: 16.610

<u>Casetype</u>	<u>Case Disp</u>			<u>Sect</u>	<u>Sur Typ</u>	<u>Sur Num</u>	<u>Suff</u>	<u>Subdivision</u>	<u>Act Pend</u>
286203	AUTHORIZED	14	0070N	0030W	024	ALIQ		SE;	

Serial Number: AZA 015036  
Total Case Acres: 7,343.026

<u>Casetype</u>	<u>Case Disp</u>			<u>Sect</u>	<u>Sur Typ</u>	<u>Sur Num</u>	<u>Suff</u>	<u>Subdivision</u>	<u>Act Pend</u>
311111	CLOSED	14	0070N	0030W	024	ALIQ		N2,N2SW,SE;	

Serial Number: AZA 022729  
Total Case Acres: 1.000

<u>Casetype</u>	<u>Case Disp</u>			<u>Sect</u>	<u>Sur Typ</u>	<u>Sur Num</u>	<u>Suff</u>	<u>Subdivision</u>	<u>Act Pend</u>
292803	PENDING	14	0070N	0030W	024	ALIQ		NENW; NENW;	Y

Serial Number: AZA 023676  
Total Case Acres: 0.918

<u>Casetype</u>	<u>Case Disp</u>			<u>Sect</u>	<u>Sur Typ</u>	<u>Sur Num</u>	<u>Suff</u>	<u>Subdivision</u>	<u>Act Pend</u>
292006	CLOSED	14	0070N	0030W	024	ALIQ		SWNE;	

Serial Number: AZA 024694  
Total Case Acres: 1.000

<u>Casetype</u>	<u>Case Disp</u>			<u>Sect</u>	<u>Sur Typ</u>	<u>Sur Num</u>	<u>Suff</u>	<u>Subdivision</u>	<u>Act Pend</u>
380913	AUTHORIZED	14	0070N	0030W	024	ALIQ		SE;	

Serial Number: AZA 025670  
Total Case Acres: 1.000

<u>Casetype</u>	<u>Case Disp</u>			<u>Sect</u>	<u>Sur Typ</u>	<u>Sur Num</u>	<u>Suff</u>	<u>Subdivision</u>	<u>Act Pend</u>
		14	0070N	0030W					

RUN TIME: 02:07 PM

UNITED STATES DEPARTMENT OF INTERIOR  
BUREAU OF LAND MANAGEMENT  
GEOGRAPHIC REPORT WITH LAND  
Sorted by Serial Number

RUN DATE: 03/29/2001  
Page 2 of 3

Adm State: AZ

380913 AUTHORIZED 024 ALIQ E2;

Serial Number: AZA 025695  
Total Case Acres: 1.000

<u>Casetype</u>	<u>Case Disp</u>	14	0070N	0030W	<u>Sect</u>	<u>Sur Typ</u>	<u>Sur Num</u>	<u>Suff</u>	<u>Subdivision</u>	<u>Act Pend</u>
380913	AUTHORIZED				024	FF		1	PART;	

Serial Number: AZA 028332  
Total Case Acres: 1.000

<u>Casetype</u>	<u>Case Disp</u>	14	0070N	0030W	<u>Sect</u>	<u>Sur Typ</u>	<u>Sur Num</u>	<u>Suff</u>	<u>Subdivision</u>	<u>Act Pend</u>
380913	AUTHORIZED				024	ALIQ			SE;	

Serial Number: AZA 030286  
Total Case Acres: 1.000

<u>Casetype</u>	<u>Case Disp</u>	14	0070N	0030W	<u>Sect</u>	<u>Sur Typ</u>	<u>Sur Num</u>	<u>Suff</u>	<u>Subdivision</u>	<u>Act Pend</u>
380913	PENDING				024	ALIQ			NE;	Y

Serial Number: AZA 030469  
Total Case Acres: 1.000

<u>Casetype</u>	<u>Case Disp</u>	14	0070N	0030W	<u>Sect</u>	<u>Sur Typ</u>	<u>Sur Num</u>	<u>Suff</u>	<u>Subdivision</u>	<u>Act Pend</u>
380913	PENDING				024	ALIQ			NW;	

Serial Number: AZA 031445  
Total Case Acres: 1.000

<u>Casetype</u>	<u>Case Disp</u>	14	0070N	0030W	<u>Sect</u>	<u>Sur Typ</u>	<u>Sur Num</u>	<u>Suff</u>	<u>Subdivision</u>	<u>Act Pend</u>
380913	AUTHORIZED				024	ALIQ			NE;	

Serial Number: AZPHX 0083587  
Total Case Acres: 13.800



RUN TIME: 02:07 PM

UNITED STATES DEPARTMENT OF INTERIOR  
BUREAU OF LAND MANAGEMENT  
GEOGRAPHIC REPORT WITH LAND  
Sorted by Serial Number

RUN DATE: 03/29/2001  
Page 3 of 3

Adm State: AZ

<u>Casetype</u>	<u>Case Disp</u>				<u>Sect</u>	<u>Sur Typ</u>	<u>Sur Num</u>	<u>Suff</u>	<u>Subdivision</u>	<u>Act Pend</u>
285003	AUTHORIZED	14	0070N	0030W	024	ALIQ			S2NE,NWSE,N2SW;	

